



1-800-477-6655  
buyritebeauty.com

# MONA LISA PEDICURE CHAIR

## CHM-2320-5H

### INSTRUCTION MANUAL

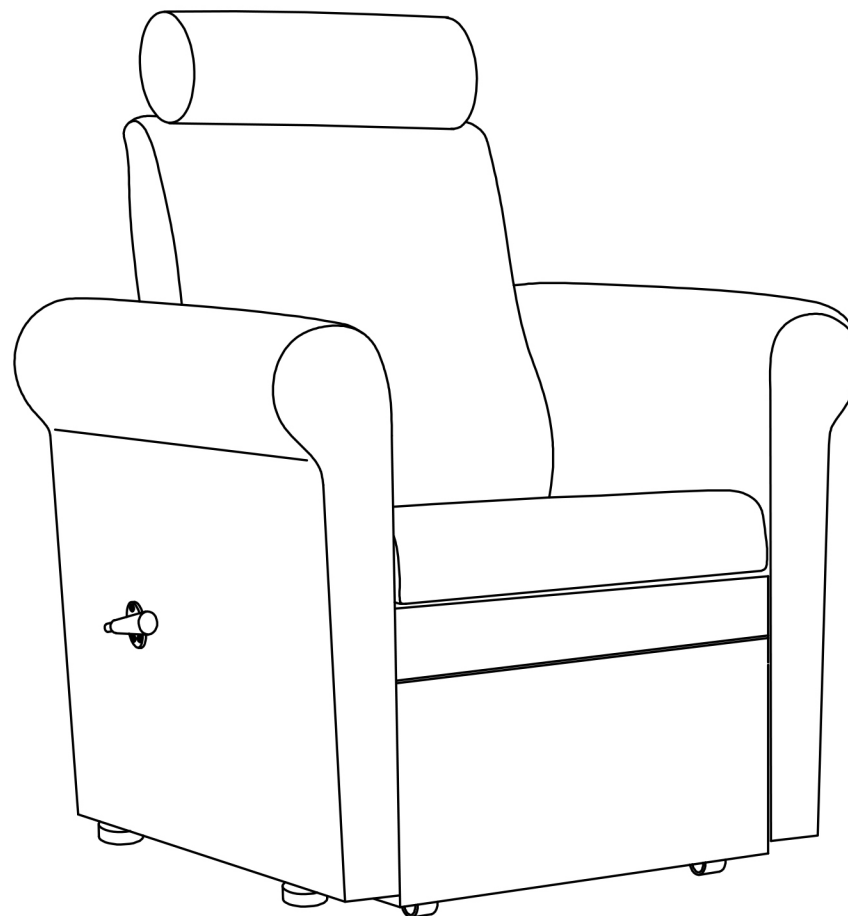

## List of Parts & Tools

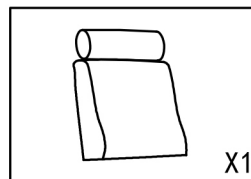

Backrest

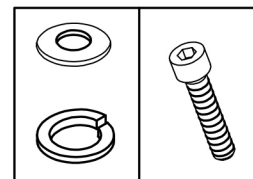

Screw and Washer

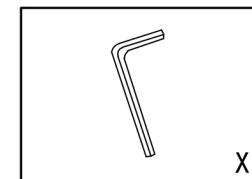

Wrench

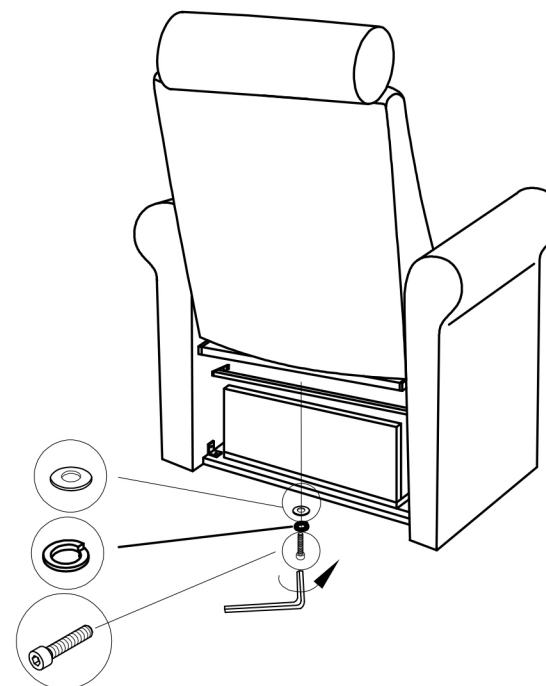
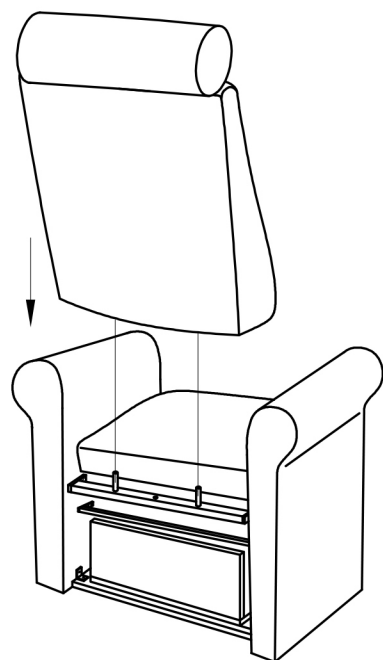

1. Find the mounting holes on the underside of the backrest. Line up these holes with the vertical posts already installed on the chair frame.
2. Carefully slide the backrest down onto the posts until it sits flush.
3. From underneath the backrest, hand-thread the washers and screw through the chair frame located in the center.
4. Once hand-tightened, use a wrench to firmly secure the connection. Apply steady pressure with the wrench until the parts are snug. Avoid overtightening, as this can strip the bolt or damage the frame.

## Product care



Brush away excess hair



Clean surface with damp cloth or use simple soap & water solution.



Avoid using corrosive cleaning agents such as bleaches.

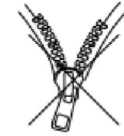

Do not remove upholstery for cleaning

## Product Information

1. Enjoy your new pedicure chair!
2. If the footrest isn't locking properly, check the center screw located underneath the front panel of the footrest to make sure it is securely tightened.
3. If you have any questions or concerns, please contact our customer experience team at 912-335-4445.