

# Mirror Board

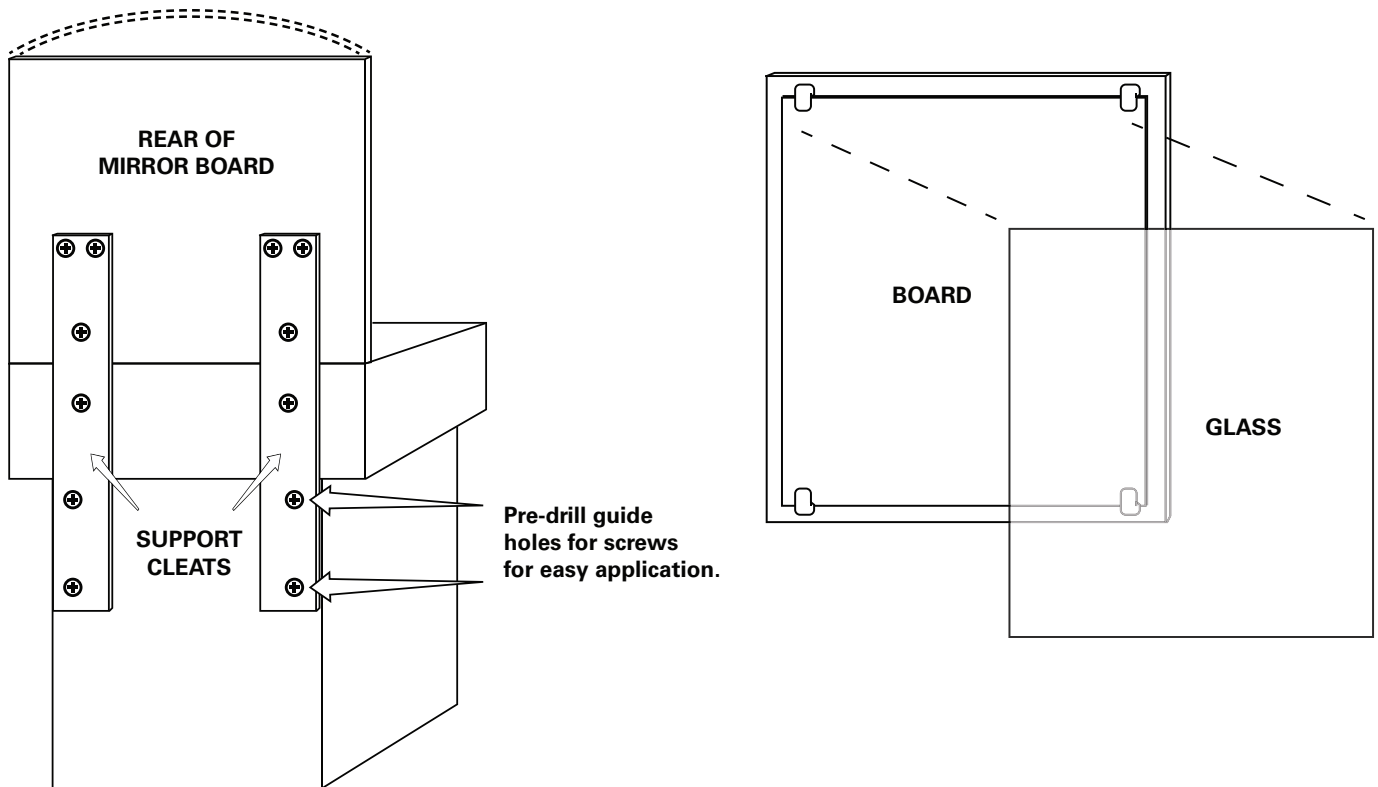

## Assembly Instructions:

1. Attach the station top to the base cabinet prior to beginning the mirror board installation (see other instruction sheets for guidance).
2. Using a 3/16" drill bit, pre-drill a total of 12 holes in the support cleats at the approximate locations as pictured.
3. Attach the support cleats by drilling (6) 1.25" screws (provided) through the pre-drilled holes in the cleats and into the base cabinet and station top.
4. Align mirror board against the support cleats and flush on both sides of the station top as pictured.
5. Attach the mirror board to the support cleats by drilling (6) 1.25" screws (provided) through the pre-drilled holes in the cleats and into the mirror board.
6. Attach the mirror to the backboard using the provided mirror clips as pictured.

## Mounting Backboard to Wall (In Lieu of Mounting to Station)

While glass is off, secure the backboard to the wall using appropriate hardware (not provided) for your particular type of wall. It is recommended that you secure the mirror board into wall studs for best results. Once the backboard has been installed against the wall, attach the mirror to the backboard using the provided mirror clips as pictured.