

ASSEMBLING YOUR

# Quick Tray

Full assembly video available at  
[www.buyritebeauty.com](http://www.buyritebeauty.com)



**1.** Attach taped base plate to tray arm with Allen screw & the lock washer provided, using a 5/32" Allen wrench, screw **MUST** be tight. Remove tape's protective layer.



**2.** Place plastic bin upside down and cleanse with alcohol to remove any debris. Use good pressure to adhere base plate to bottom of bin.



**3.** Place the flat washer on chair rod, then insert bolt into narrow end of clamp. Flipping upside down, tighten nut to secure.

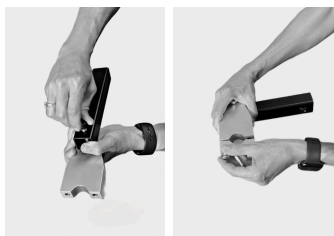

**4.** Loosely attach other end of clamp with matching bolts for later tightening

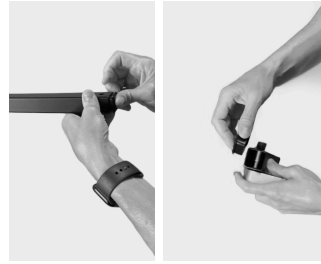

**5.** Place end caps on both tray arm and chair rod



**6.** Loosely attach adjustable screw in chair rod for later positioning of Quick Tray



**7.** With chair positioned at it's highest setting, attach clamp (with narrow end facing back of chair) around the very top of chair stem. Using a 1/2" wrench (or socket wrench) tighten securely.

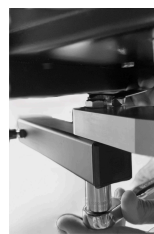

**8.** Using 9/16" standard wrench simultaneously with 9/16" socket wrench, tighten top and bottom of chair rod/clamp. **\*NOTE:** do not tighten completely - leave enough mobility to pivot



**9.** Insert the arm of your Quick Tray into the chair rod to desired depth and tighten adjustable screw to secure.

**Your tray is now ready for use!  
Enjoy!**