

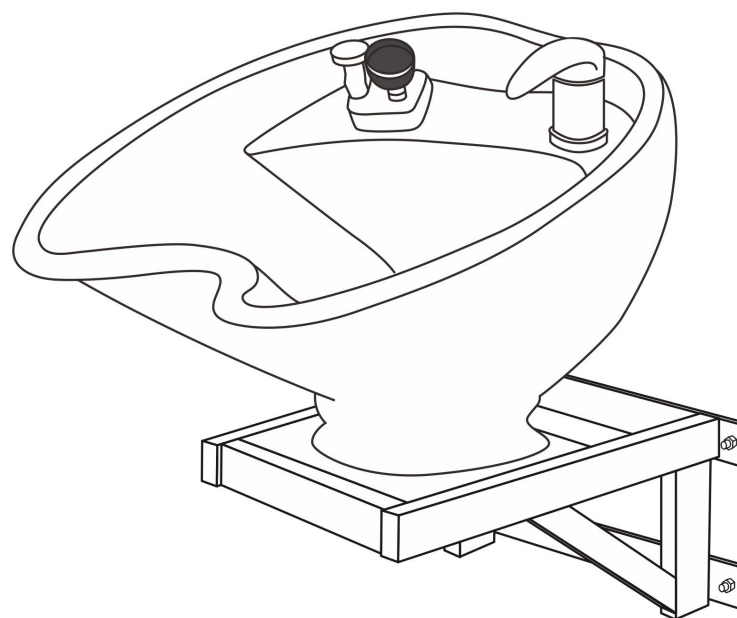

1-800-477-6655
buyritebeauty.com

WALL MOUNTED TILTING BRACKET NIN-050

INSTRUCTION MANUAL



List of Parts & Tools

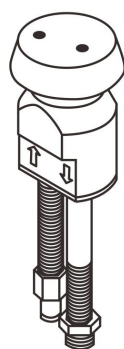

X1

Vacuum Breaker



X1

Vacuum Breaker Hose



X1

Shampoo Nozzle
& Shampoo Hose

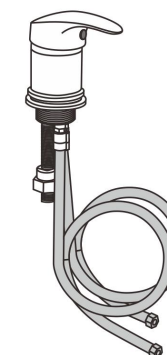

X1

Shampoo Fixture



X1

Drain Hose



X1

Neck Rest

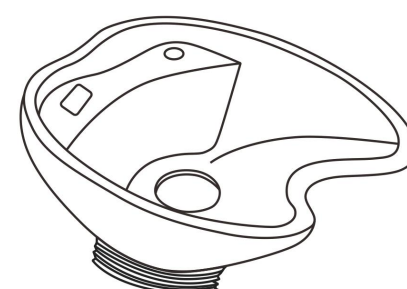

X1

Porcelain Bowl and
Tilting Mechanism

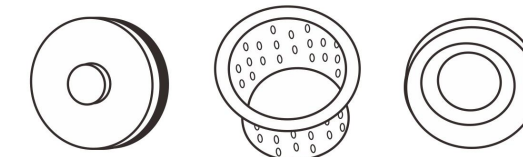

X1

Strainer Basket

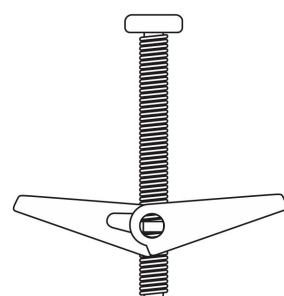

X4

Toggle Bolt for
Metal Studs

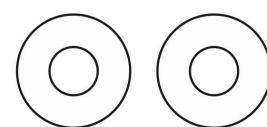

X8

Washer



X4

Wood Screw for
Wooden Studs

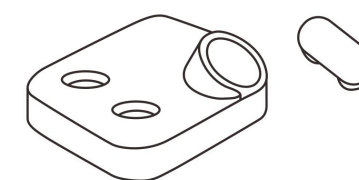

X1

Receiver Plate

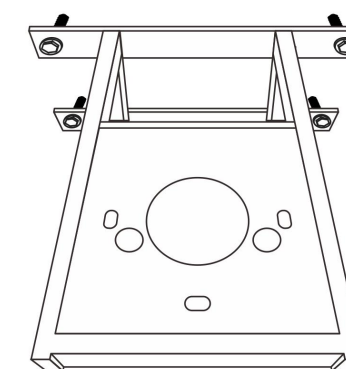

X1

Bracket

Step1

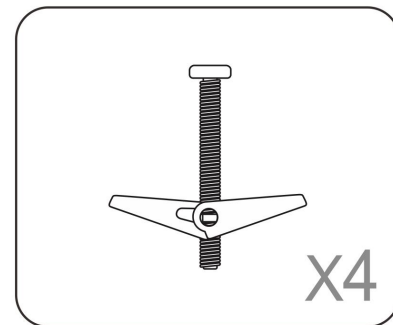

Toggle Bolt

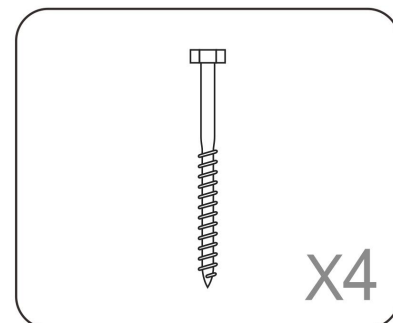

Wood Screw

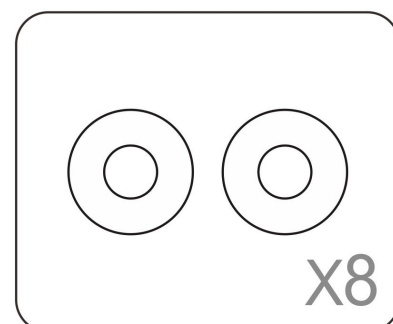

Washers

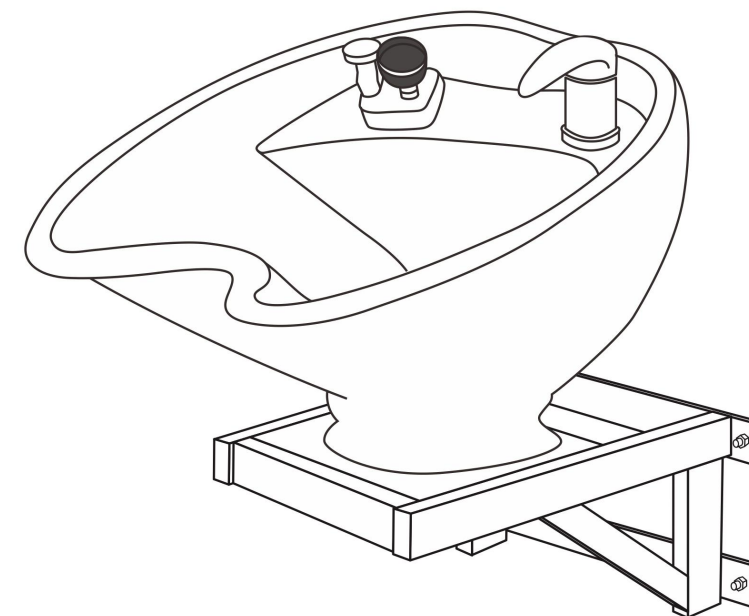
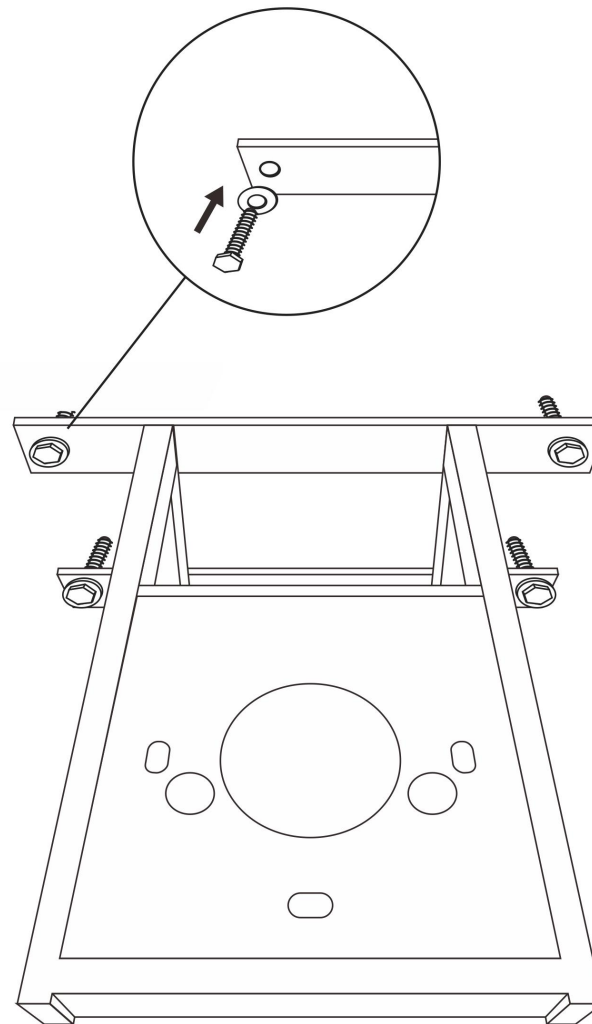

1. Choose the correct mounting hardware based on your wall type. Use the included toggle bolts for walls with metal studs, and the provided wood screws for walls with wooden studs. If your wall is made of a different material, please purchase the appropriate mounting hardware separately.
2. Use a stud finder to locate the wall studs and determine where to position the bracket. For secure installation, the bracket must be anchored directly into the studs.
3. Hold the bracket in place and mark the top left hole.
4. Level the bracket, then mark the remaining four holes. Note: Horizontal holes are spaced 16 inches apart to match standard stud spacing.
5. Drill pilot holes that are slightly smaller than the provided hardware.
6. Add washers to the selected fasteners and secure the bracket to the wall as shown in the diagram above.

Step2

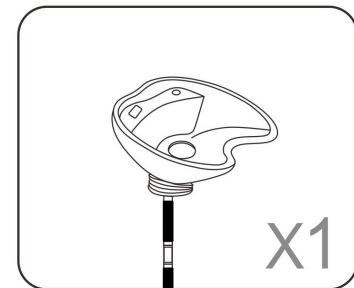

Porcelain Bowl

Bracket

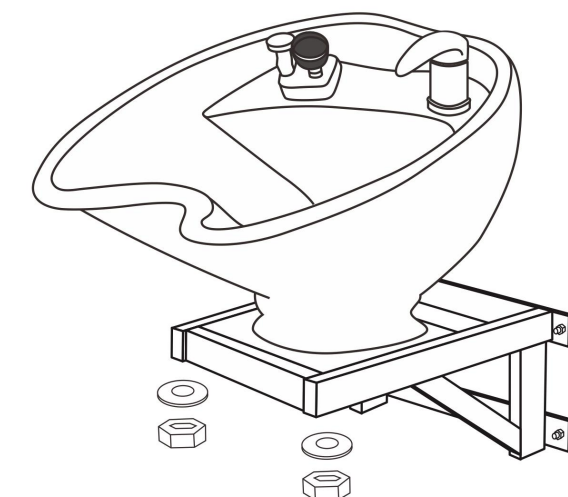
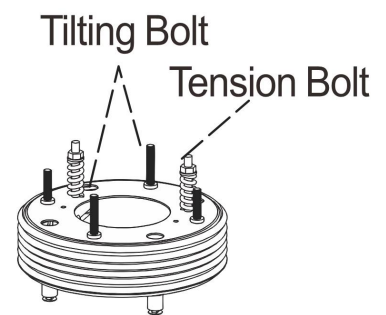
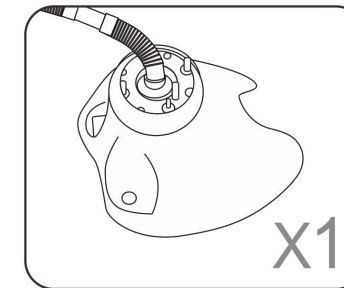
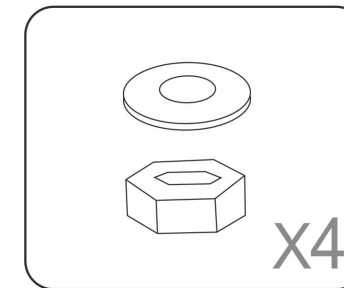
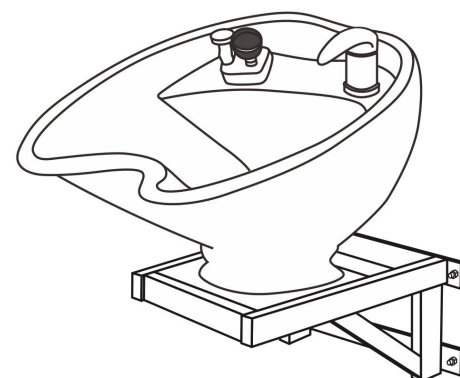
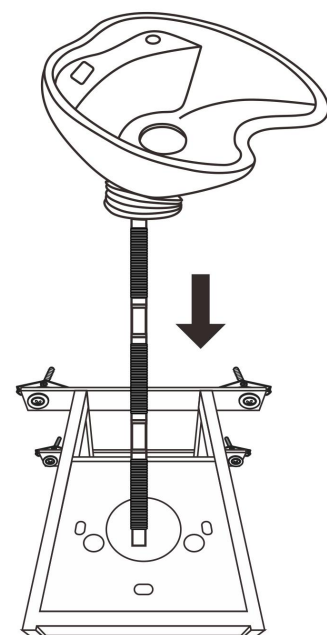
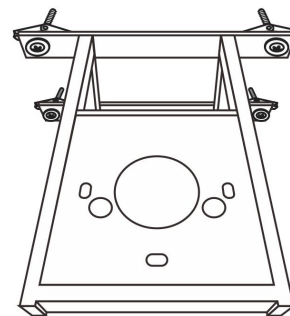
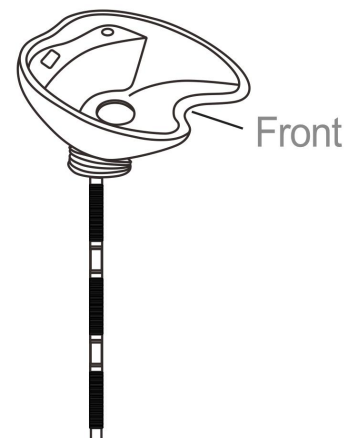
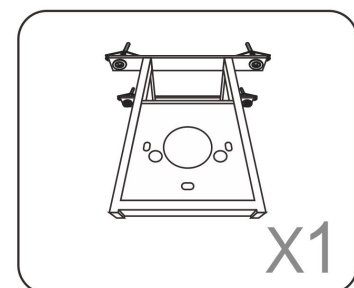

1. To attach the shampoo bowl to the bracket, begin by attaching the Drain Hose to the bottom of the Drain Assembly using the adjustable clamp. If you notice any leaks, apply plumber's putty or Teflon tape as needed to ensure a watertight seal at your licensed plumbers discretion.
2. Next, take the shampoo bowl and ensure that it is facing forward. Remove the four large washers and nuts from the bottom of the tilting mechanism as shown in the diagram above. Ensure the bolts on the bottom of the tilting mechanism align with the holes in the top of the bracket.
3. Once the tilting mechanism is aligned and seated on the bracket, attach the shampoo bowl from the underside of the bracket using the four large washers and nuts provided. Twist the nuts clockwise to tighten until secure.

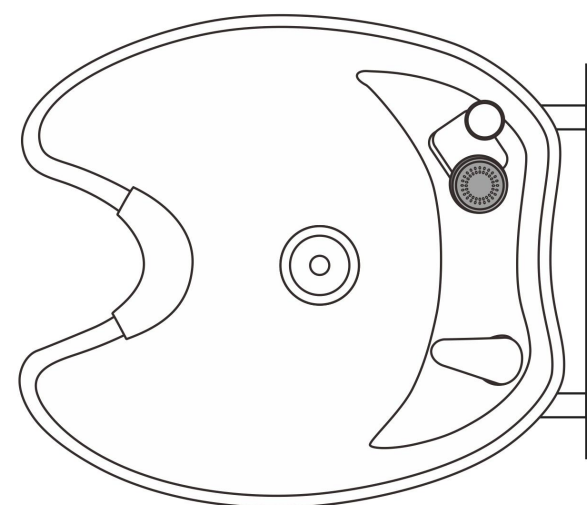
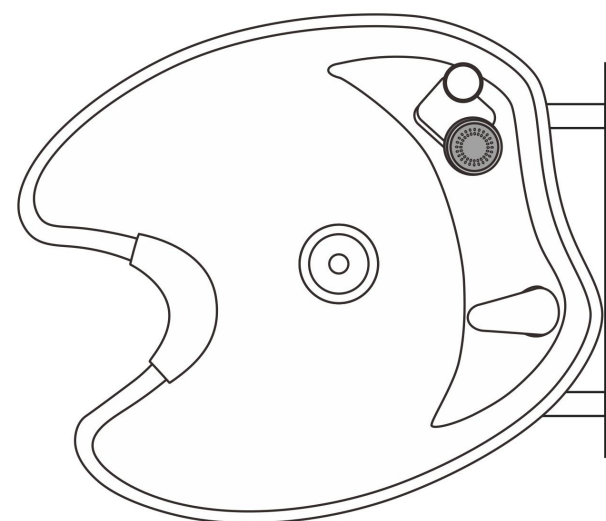
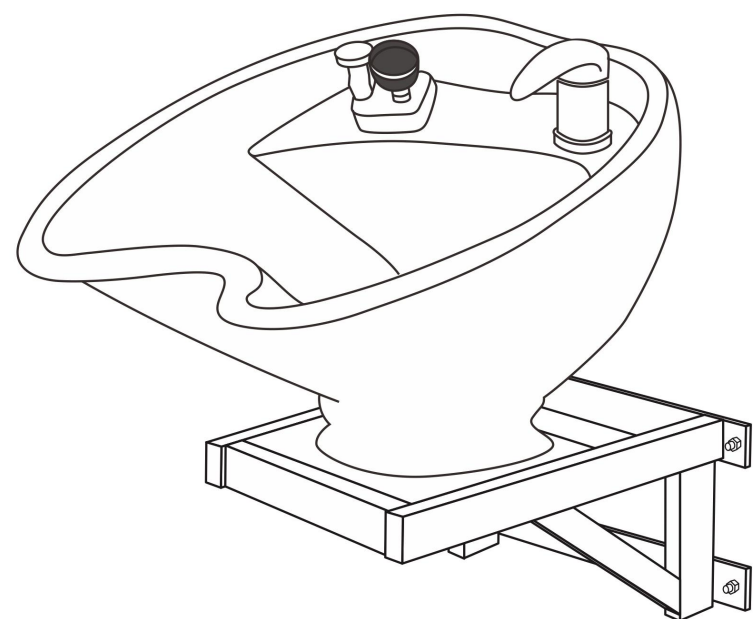

Step3

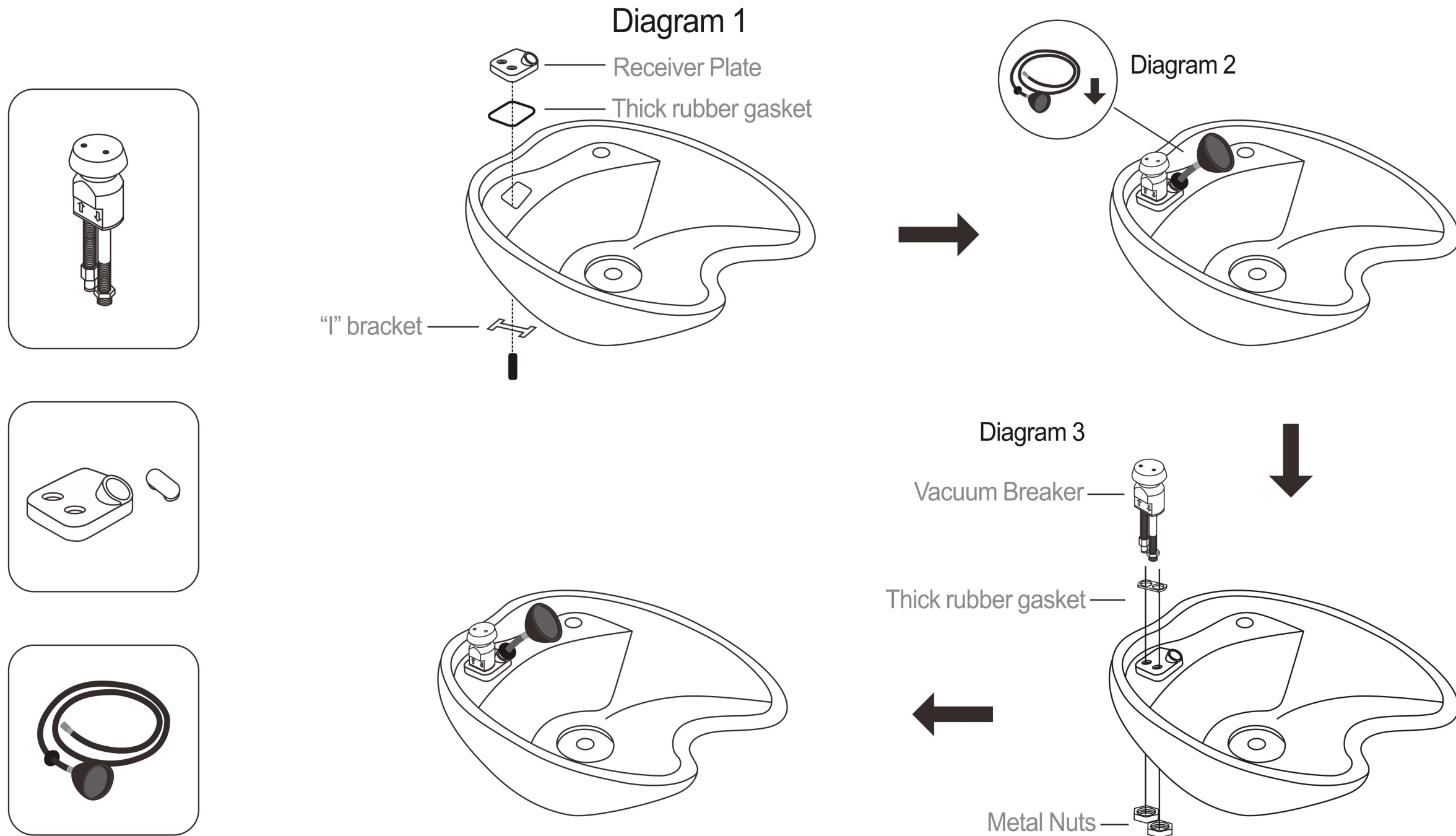

1. Attach the receiver plate to the shampoo bowl using the metal "I" bracket and nut provided as shown in diagram one.
2. Once the receiver plate is attached, install the shampoo hose and shampoo nozzle that will rest in the receiver plate as shown in the diagram two.
3. Unscrew the two metal nuts from the bottom of the vacuum breaker. Once the metal nuts have been removed, place the vacuum breaker in the receiver plate and reattach the nuts from underneath to tighten. See diagram three above.

Step4

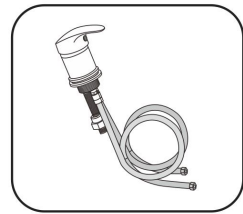

Shampoo Fixture

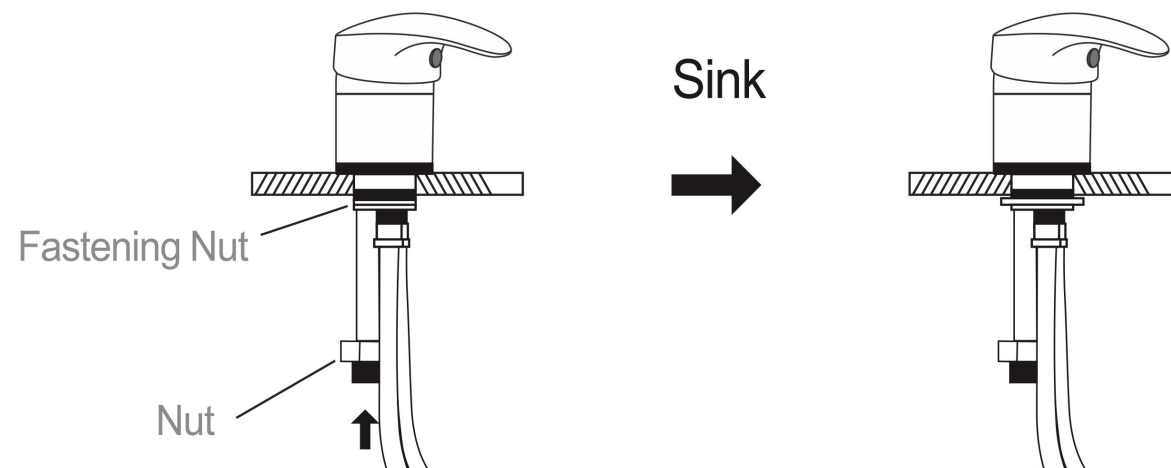
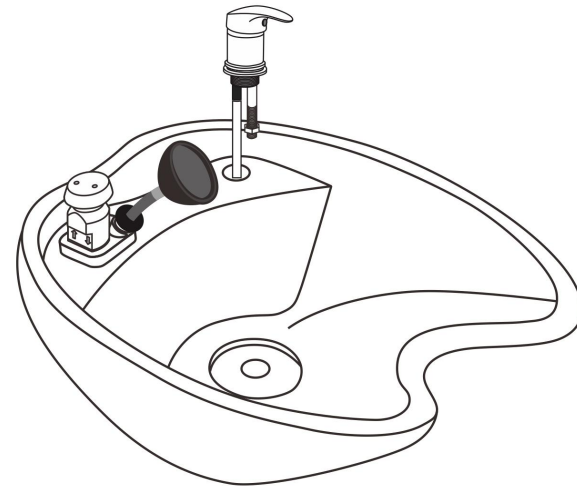

1. Loosen the small nut located at the bottom of the shampoo fixture, then remove the fastening nut from the top of the fixture.
2. Position the fixture onto the shampoo bowl once the fastening nut has been removed. Then, reattach and tighten the fastening nut to secure the fixture in place. See diagram above.

Shampoo Hose and Vacuum Breaker Hose

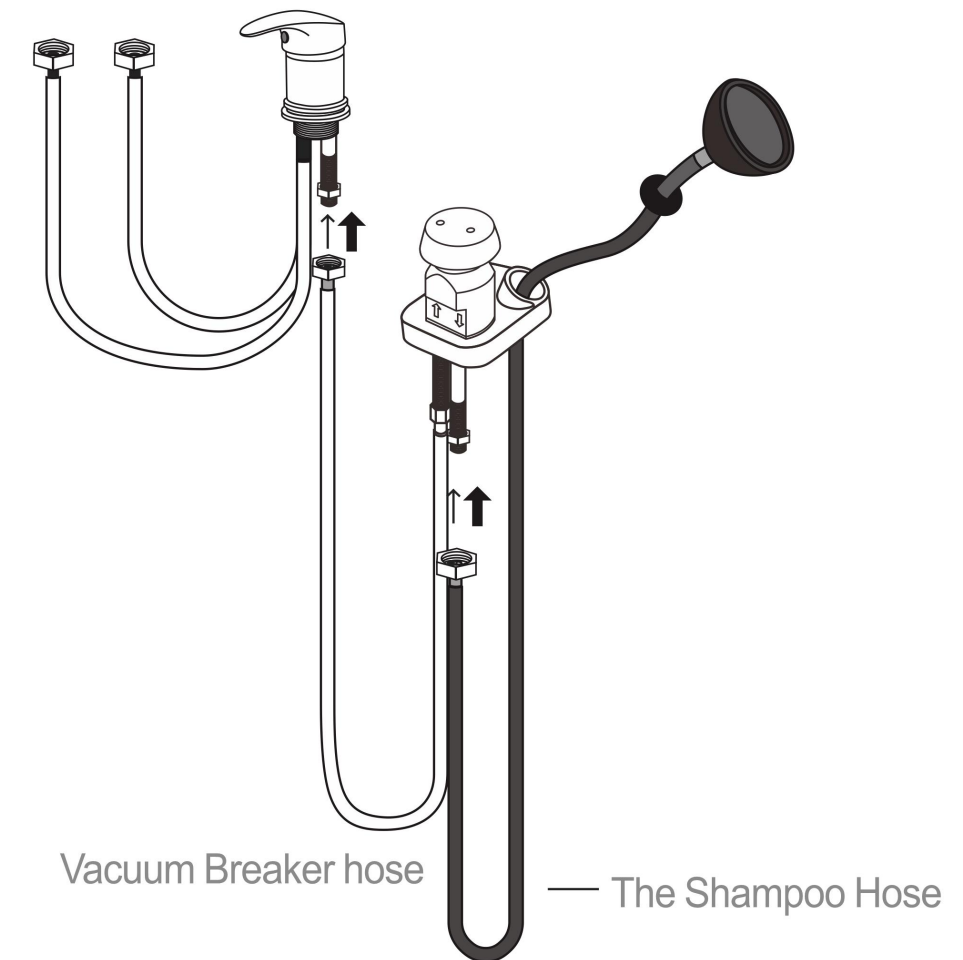

1. Attach the bottom of the shampoo hose to the bottom of the vacuum breaker as shown in the diagram above.
2. Using the vacuum breaker hose, connect the bottom of the vacuum breaker to the bottom of the shampoo fixture as shown in the same image.
3. For proper installation, ensure the shampoo hose is connected to the side of the vacuum breaker marked with a down arrow (↓), and the vacuum breaker hose is connected to the side marked with an up arrow (↑).

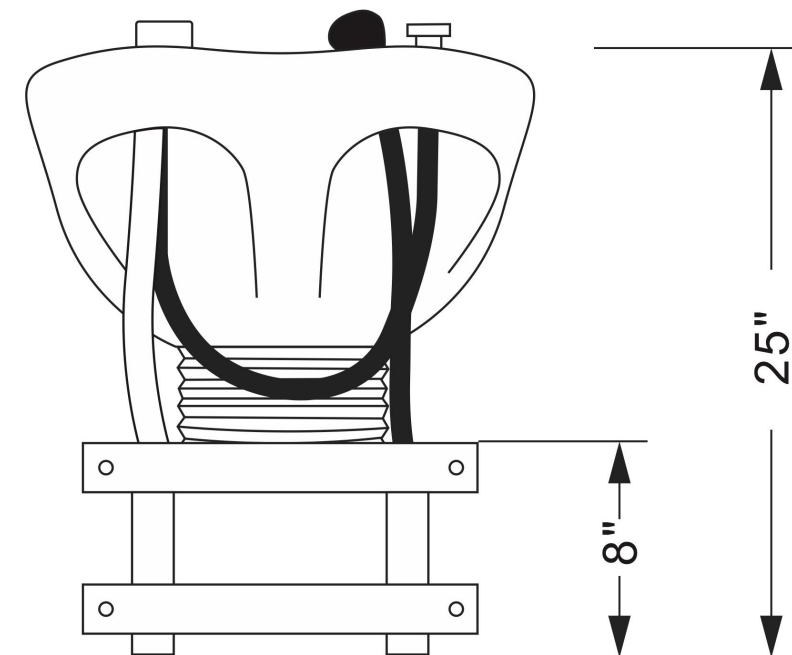
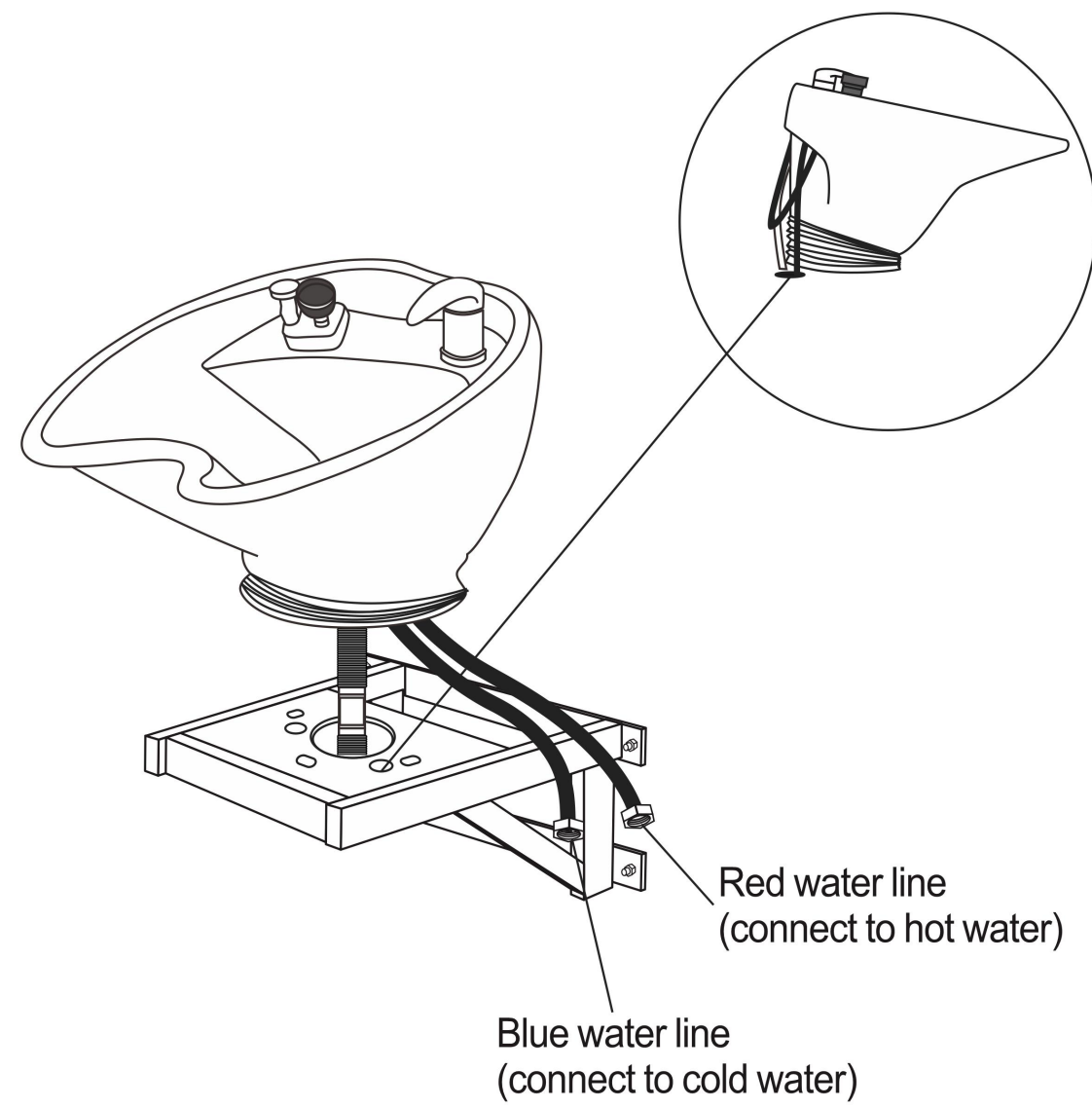

Product care



Brush away excess hair

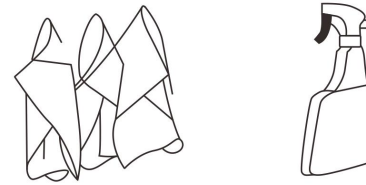

Clean surface with damp cloth or
use simple soap & water solution

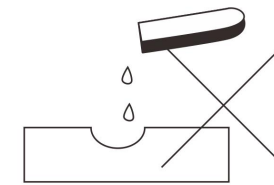

Avoid using corrosive clean-
ing agents such as bleaches

Product Information

- 1.Enjoy your new Wall Mounted Tilting Bracket!
- 2.Every local jurisdiction will have their own code for how plumbing needs to be installed. In order to maintain a valid warranty, you must have a license plumber perform the installation.
- 3.Buy-Rite Beauty is not liable for the installation of the wall bracket. Please ensure that a licensed contractor is used for proper mounting.
- 4.Ensure the drain hose is installed with a downward slope to allow gravity to provide proper drainage.
- 5.If you have any questions or concerns, please contact our customer experience team at 912-335-4445.