

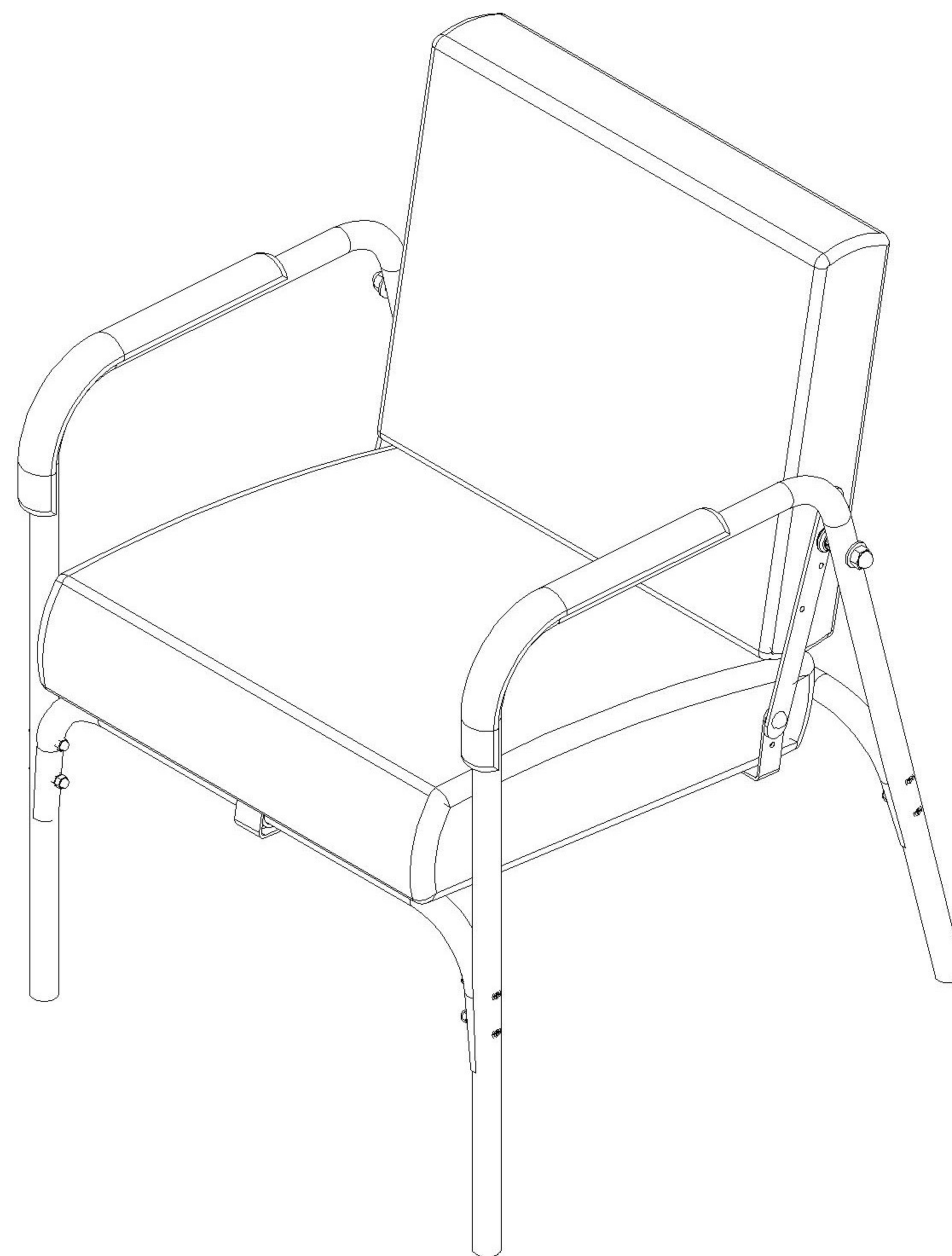

1-800-477-6655
buyritebeauty.com

**KATE SHAMPOO CHAIR
SY-9227-2
INSTRUCTION MANUAL**



List of Parts & Tools

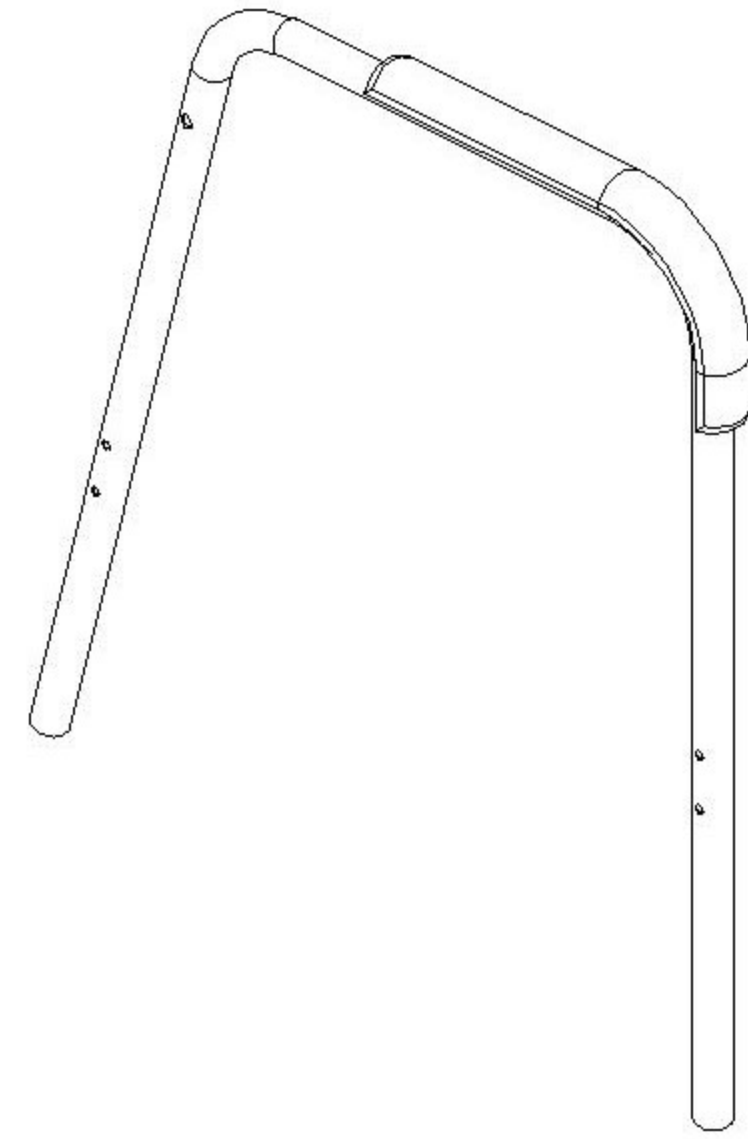

X2

Arm Frame

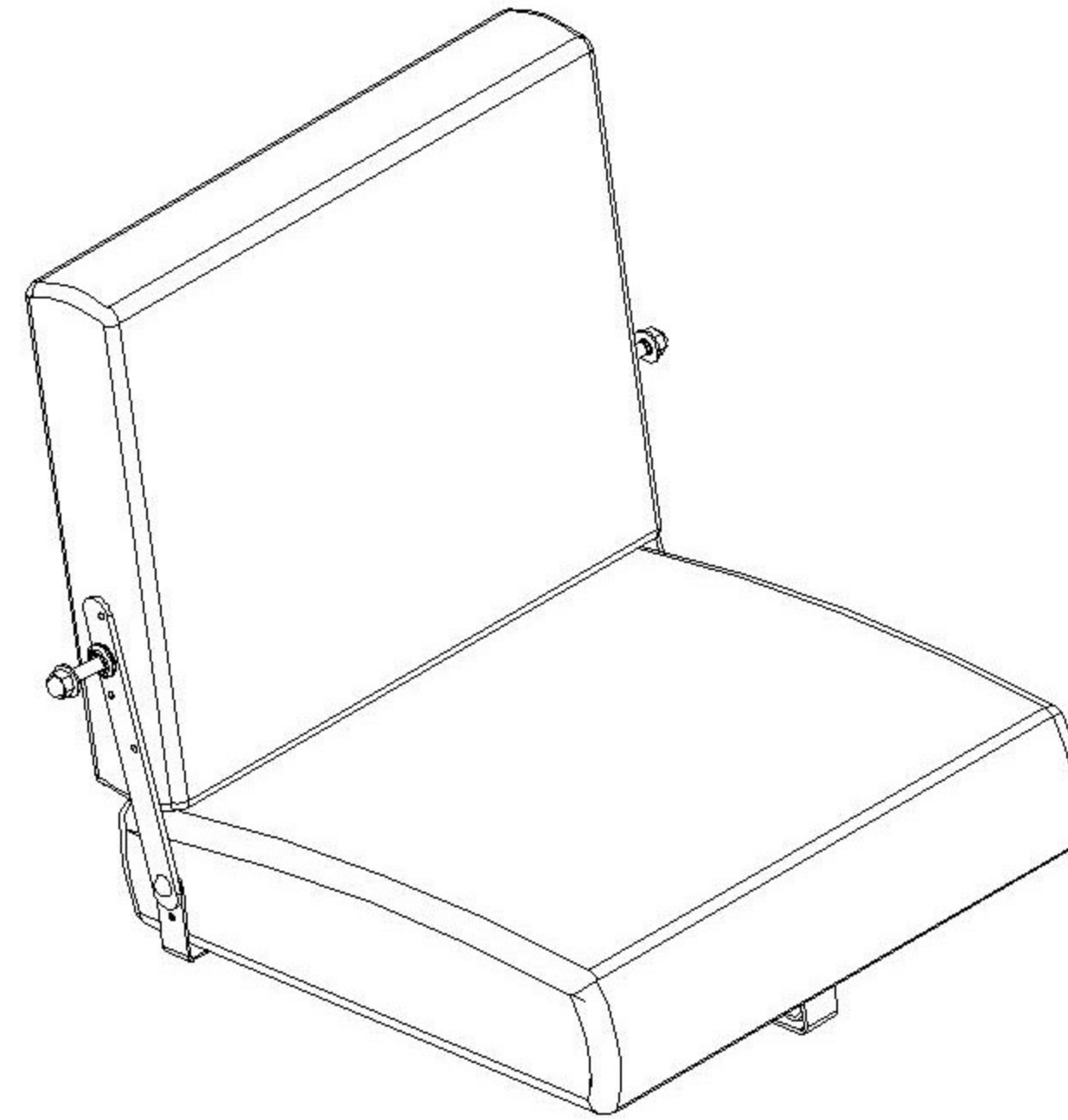

X1

Seat Cushion & Backrest

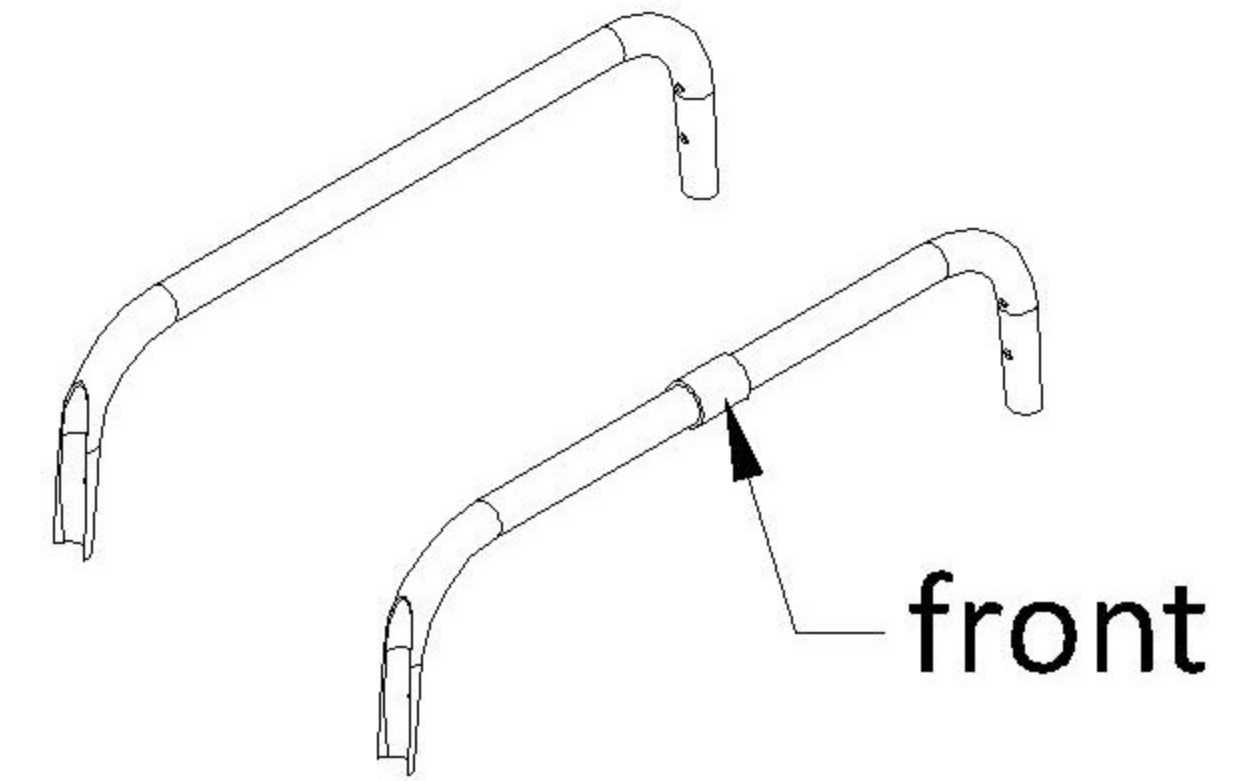

X2

Support Bars

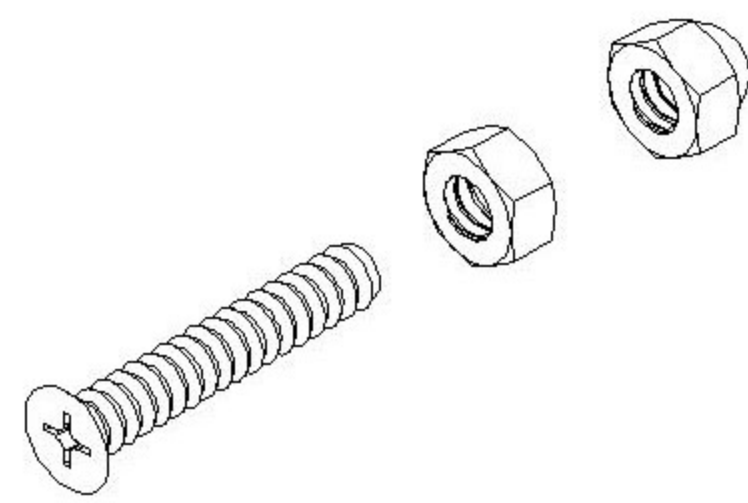

X8

M6x35

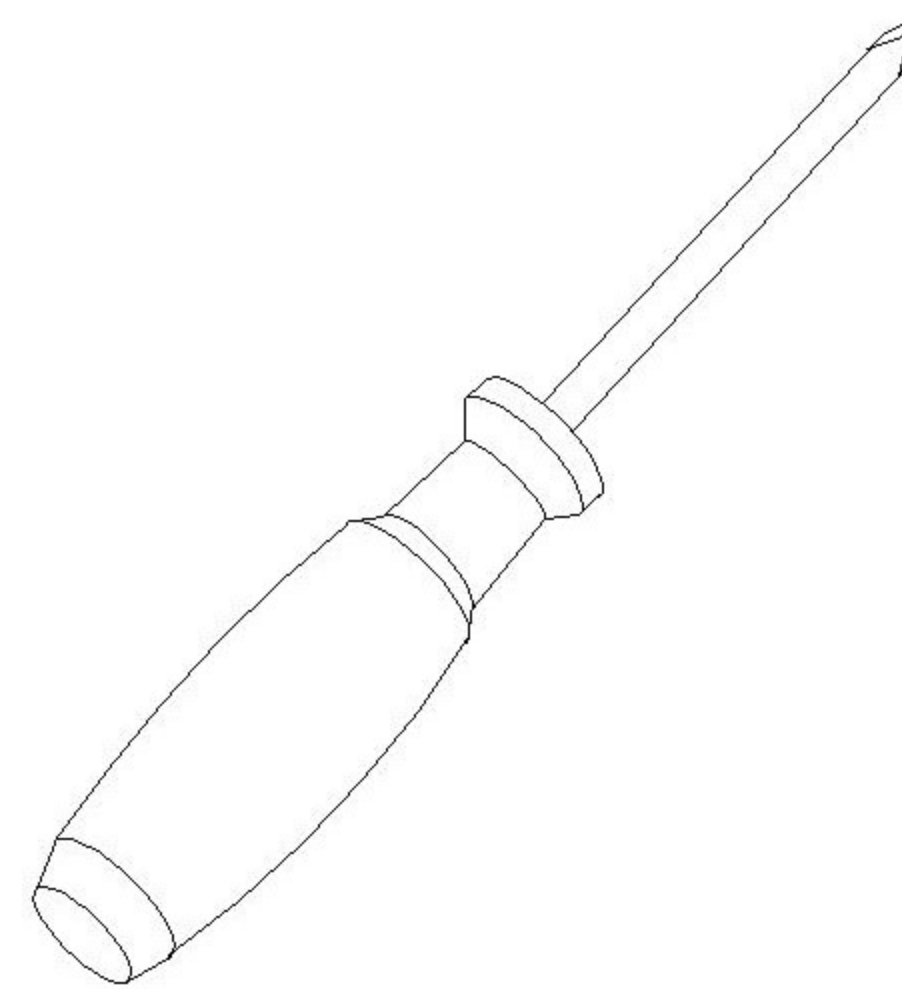

X1

Phillips Screwdriver
(Not Included)

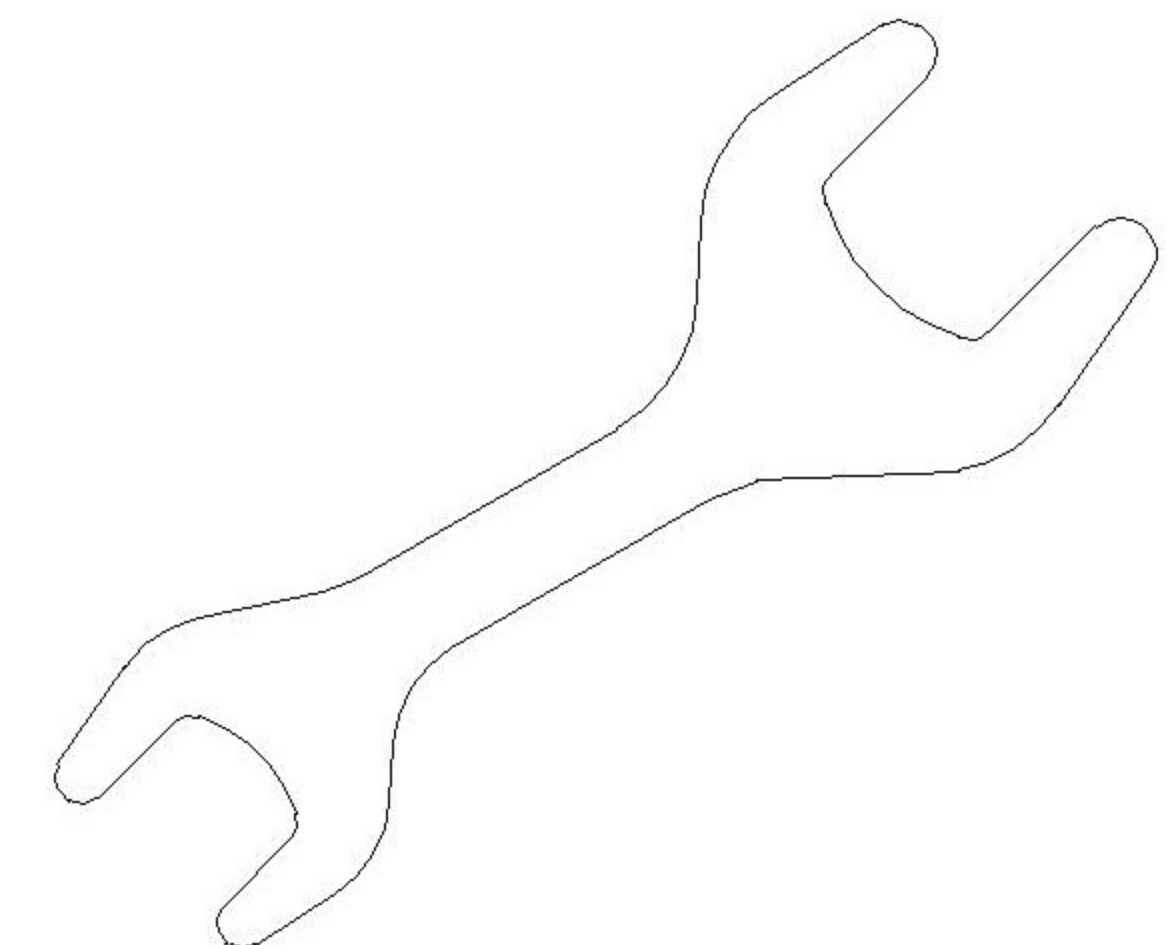

X1

10mm/19mm Open End Wrench
(Not Included)

Step 1

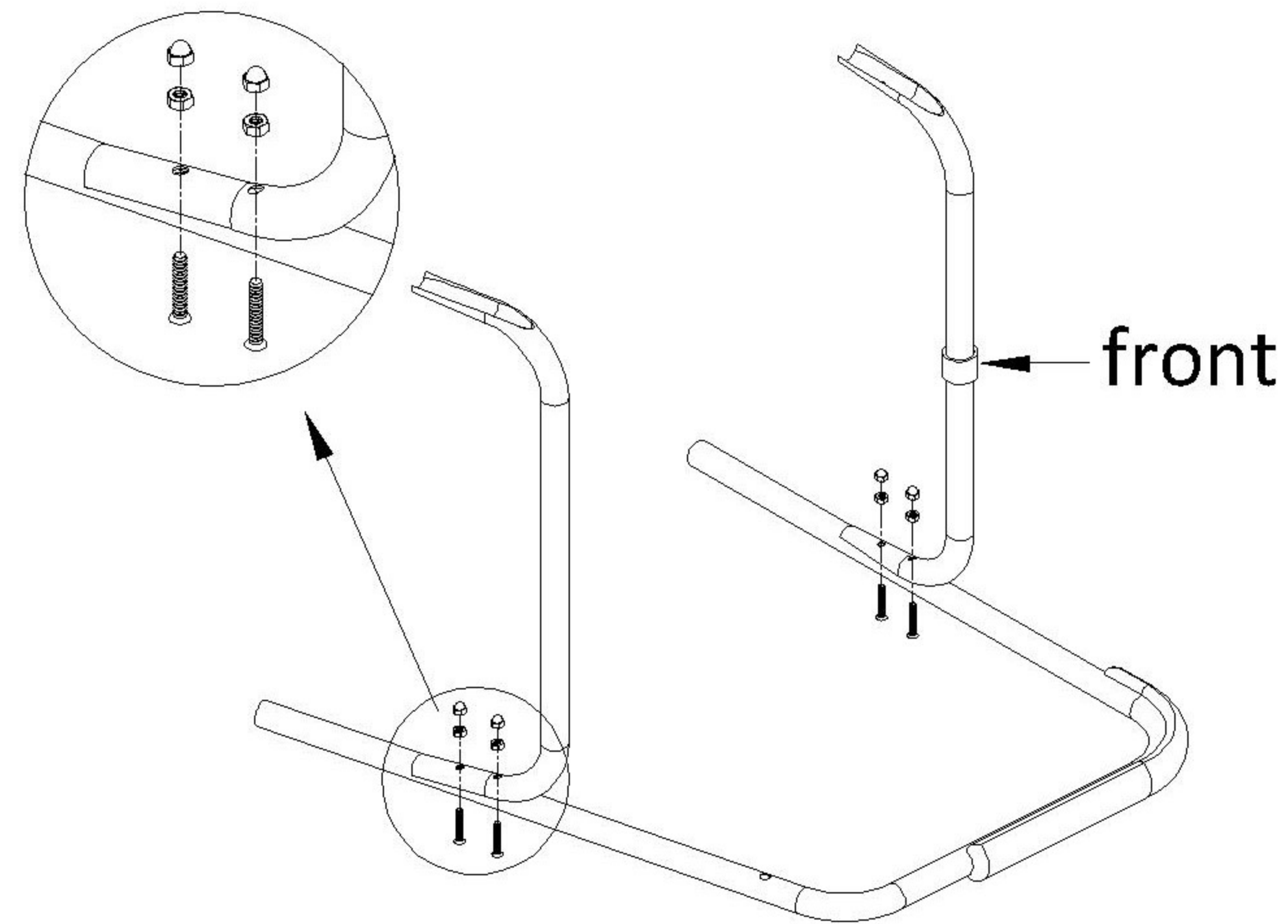
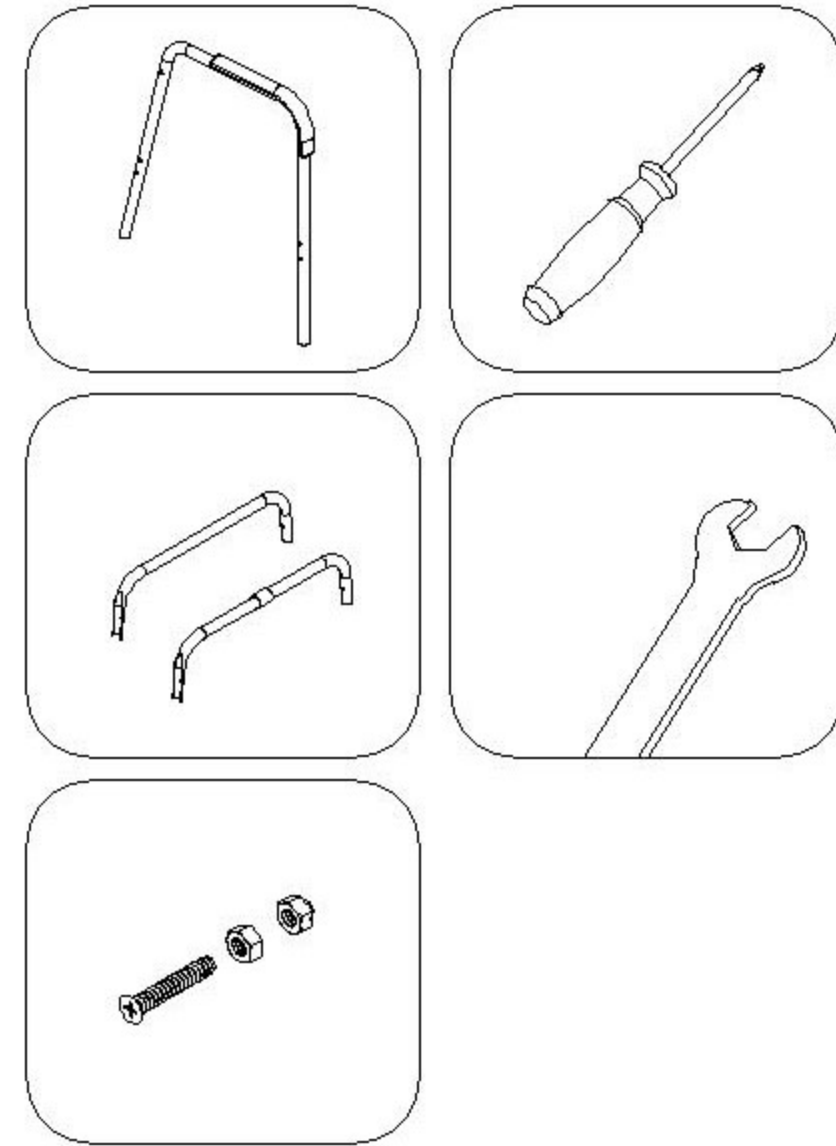

1. Locate the arm frame and lay it flat on the floor in a dry, clean location. The front of the frame is identified by the location of the arm cushion.
2. Locate the two support bars and position them to align the mounting points with the holes in the arm frame.
3. Using the provided M6 bolts, attach each support bar to the arm frame by first inserting the bolts through the mounting holes in both parts. Once the bolt has been inserted, on the opposite side, place the square nut onto the bolt, followed by the lock nut as shown in the diagram above.
4. Ensure the support bar with the plastic guide is installed in the front position.

Step 2

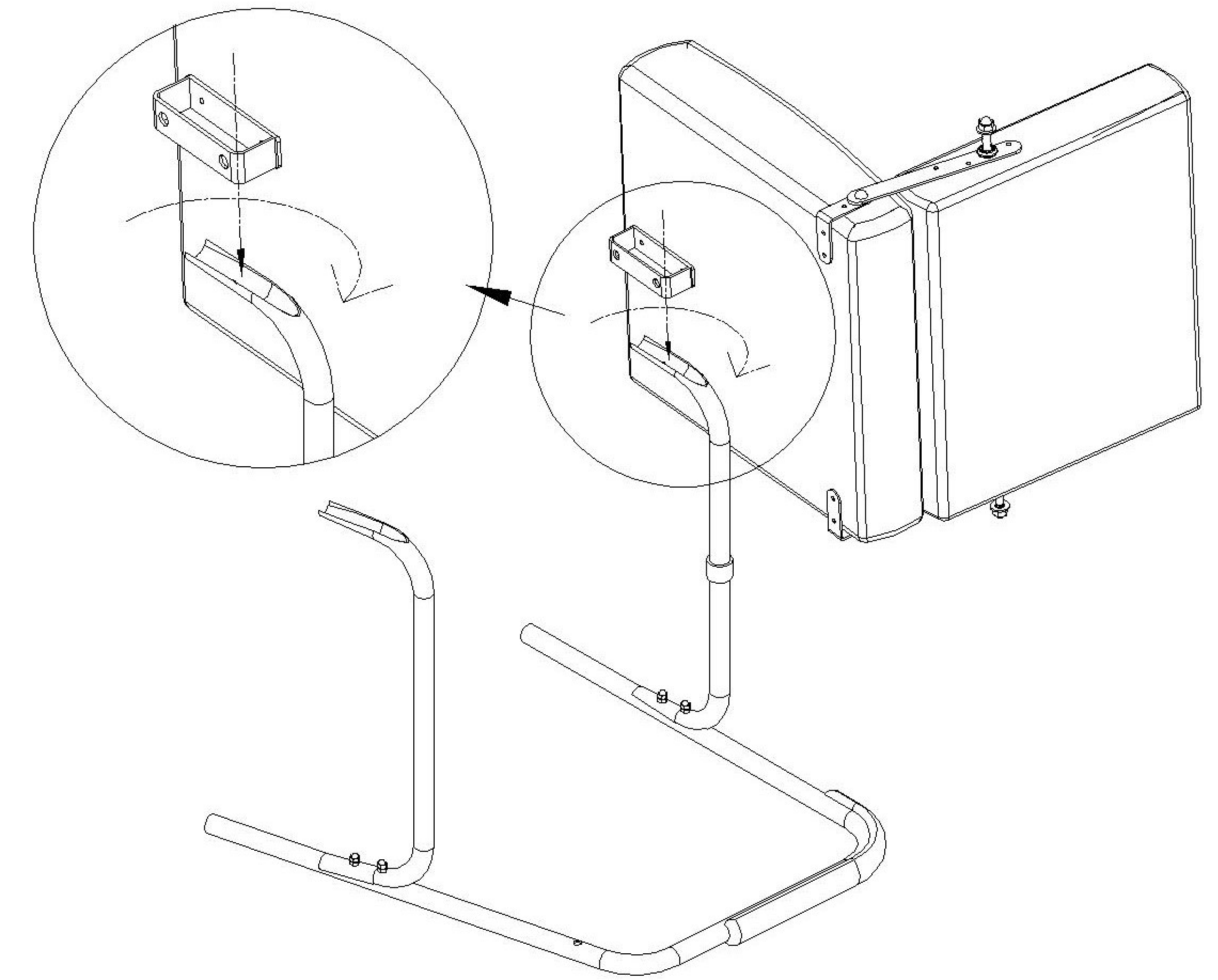
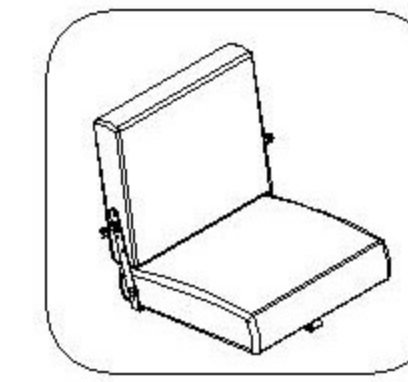

1. While the chair is still on its side, slide the front support bar through the guide bracket on the underside of the seat cushion as shown in the diagram above.

Step 3

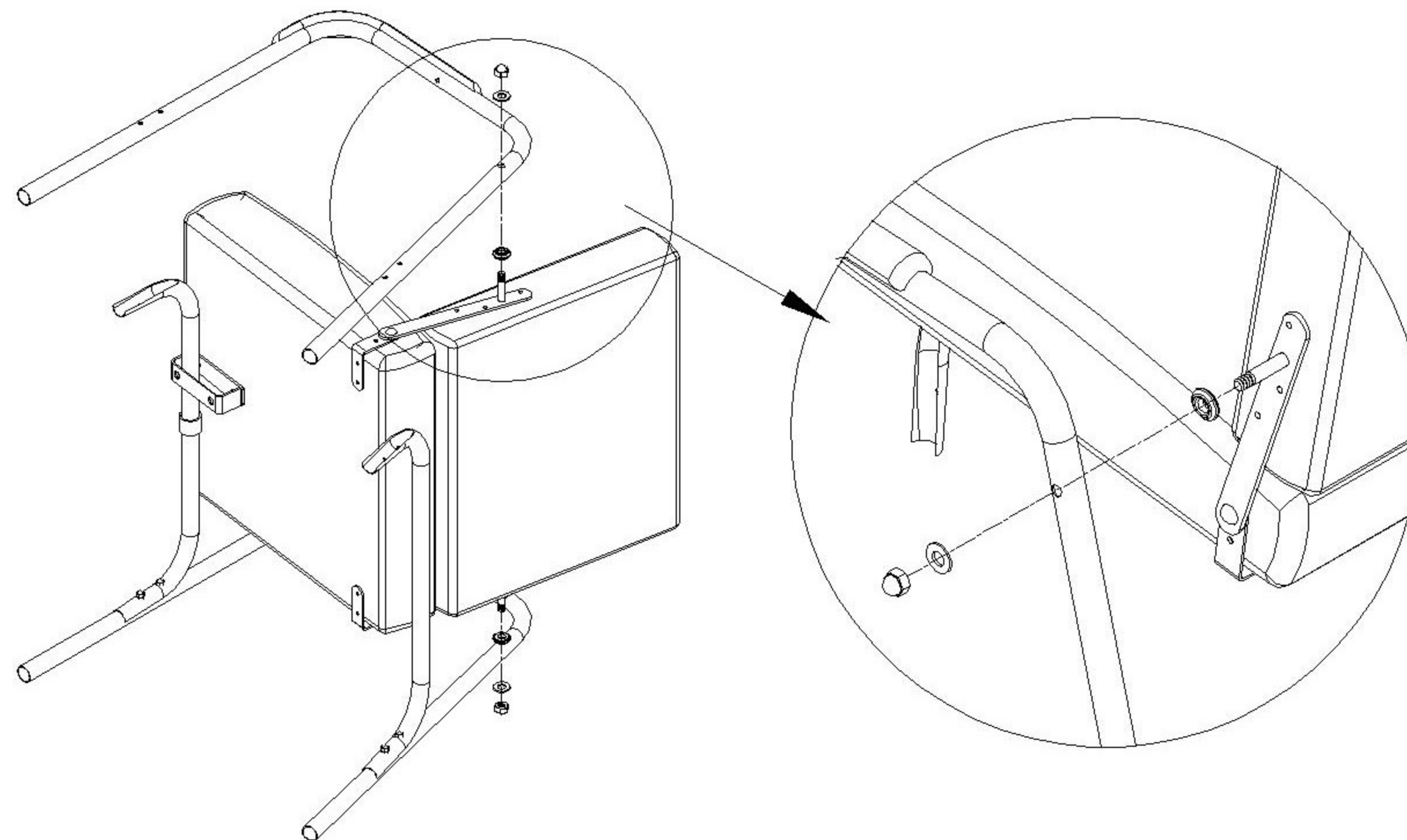
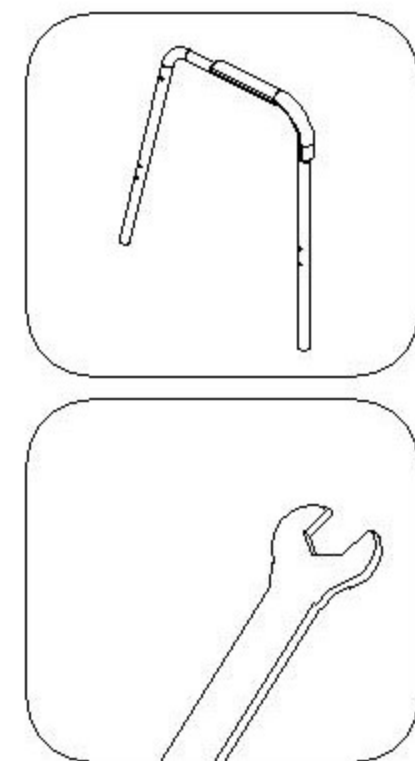

1. Locate the bracket on the side of the backrest and remove the lock nut and metal washer, leaving the white washer in place. Slide the metal backrest bar into the mounting hole of the arm frame and reattach the washer and lock nut to secure it in place.

Step 4

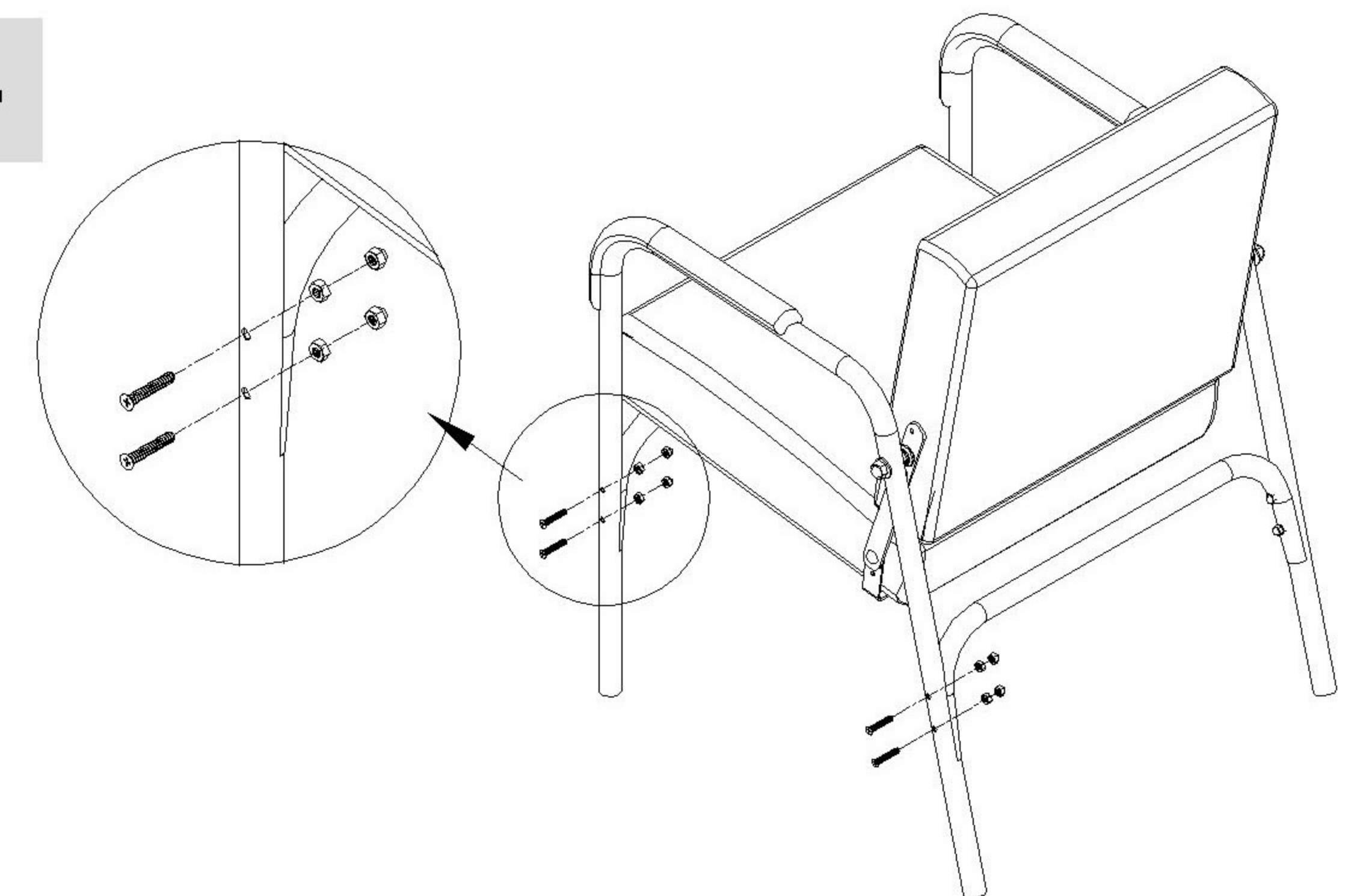
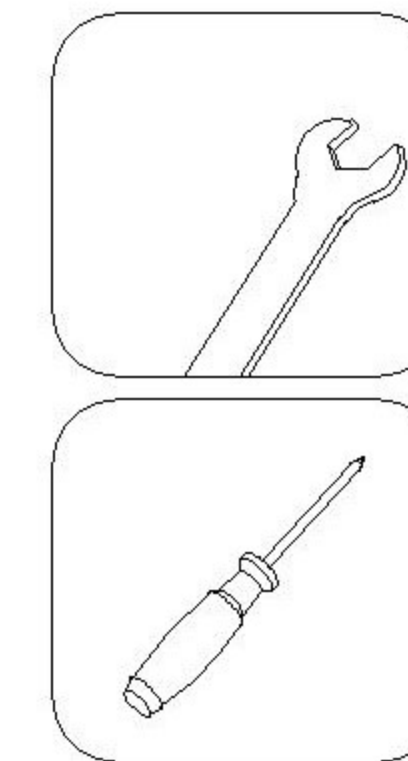

1. Turn the chair to the opposite side and repeat steps 1 and 3 to attach the second arm frame to the chair.
2. Once complete, ensure all nuts are securely tightened.

Product care



Brush away excess hair

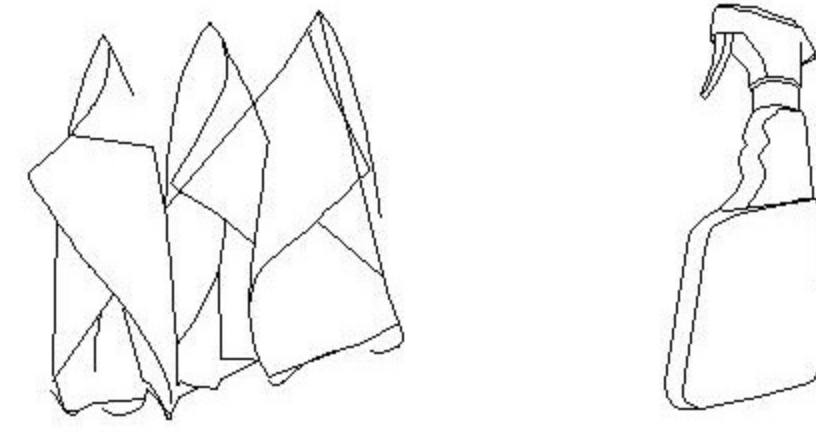

Clean surface with damp cloth or use simple soap & water solution.

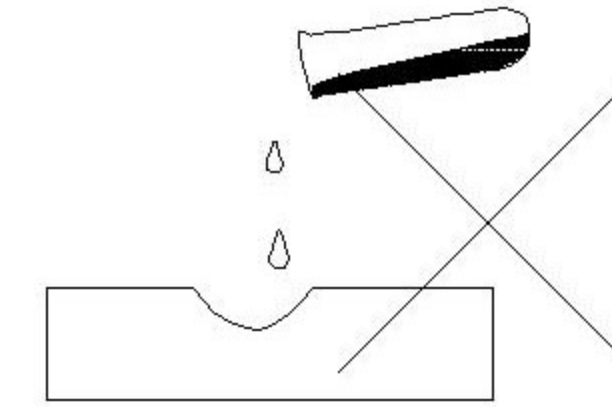

Avoid using corrosive cleaning agents such as bleaches.

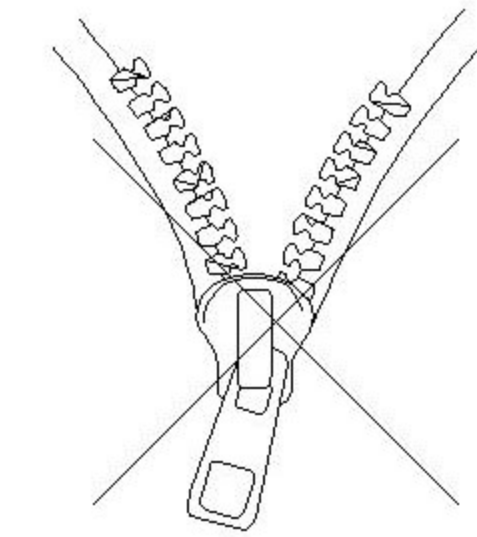

Do not remove upholstery for cleaning

Product Information

1. Enjoy your new chair!
2. If you have any questions or concerns, please contact our customer experience team at 912-335-4445.