

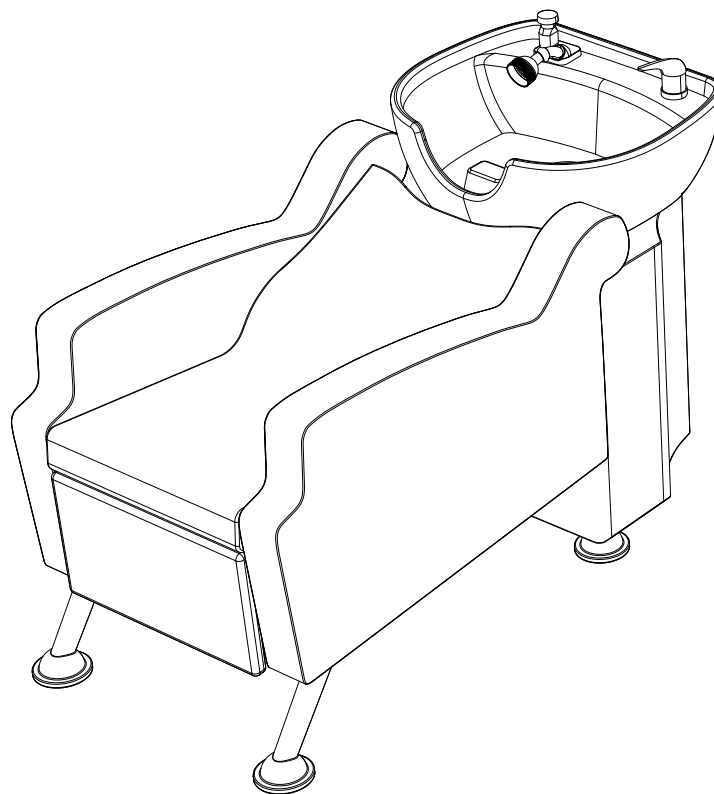

1-800-477-6655
buyritebeauty.com

OASIS BACKWASH TS-8076

INSTRUCTION MANUAL



List of Parts & Tools

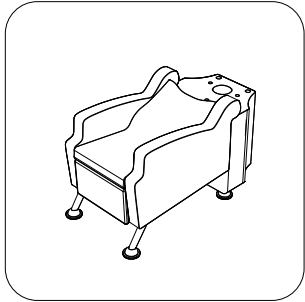

Shampoo Chair

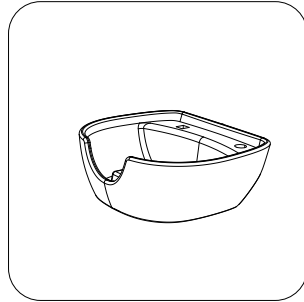

Porcelain Bowl

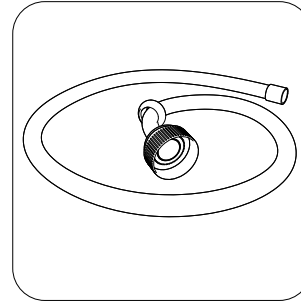

Shampoo Nozzle
& Shampoo Hose

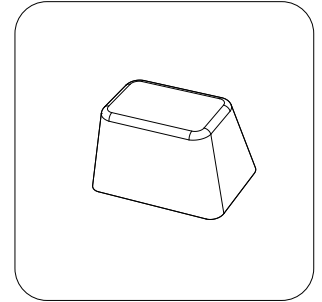

Neck Rest

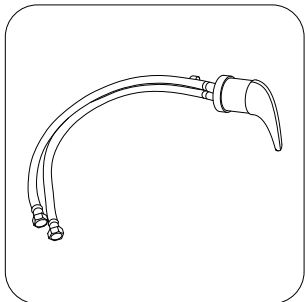

Shampoo Fixture

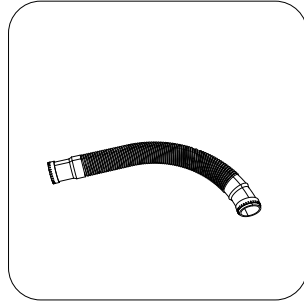

Drain Hose

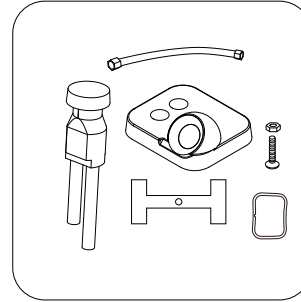

Vacuum
Breaker,
Receiver Plate &
Vacuum Breaker
Hose

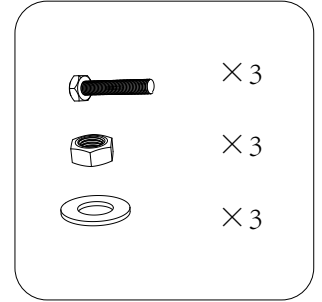

Porcelain
Bowl
Hardware
(Pre-Installed)

Step 1

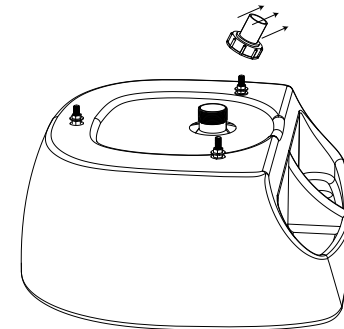
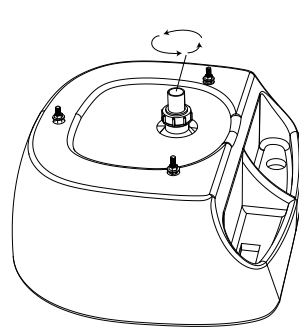
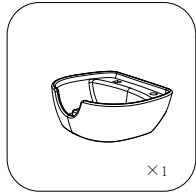

Mounting bolts

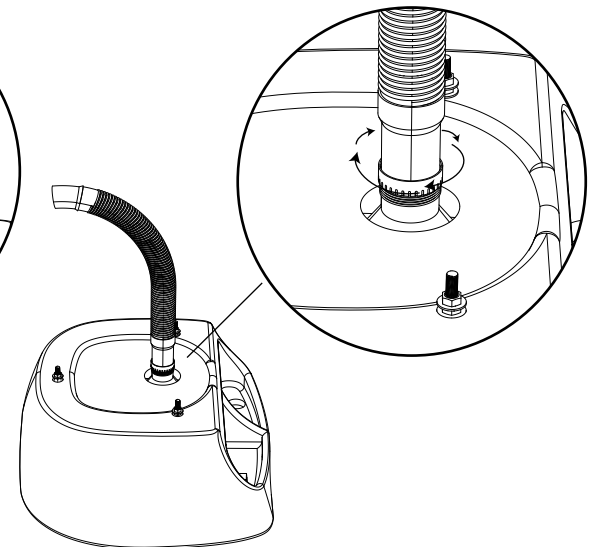
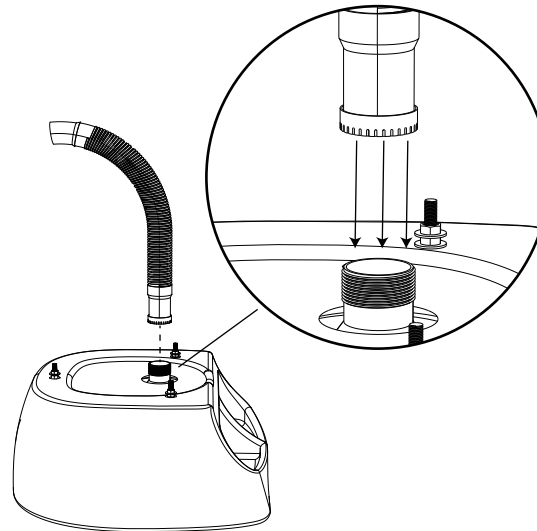
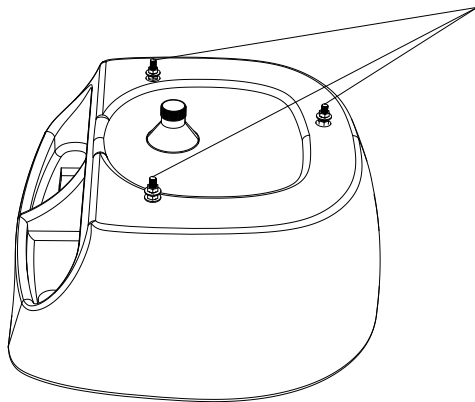

1. As shown in the top diagram, remove the tail-pipe that is pre-installed on the drain of the shampoo bowl. This part helps with protection during shipping and can be used with alternative drain hoses so it will not be needed for standard installation.
2. Attach the Drain Hose to the bottom of the Drain Assembly as shown in the diagram above. If you notice any leaks, apply plumber's putty or Teflon tape as needed to ensure a watertight seal at your licensed plumber's discretion.

Step 2

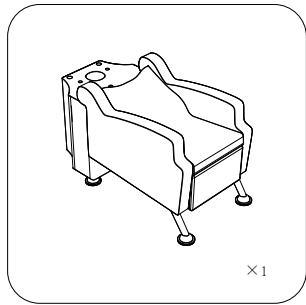
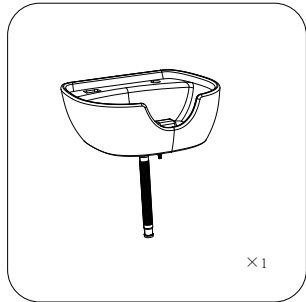

Porcelain Bowl

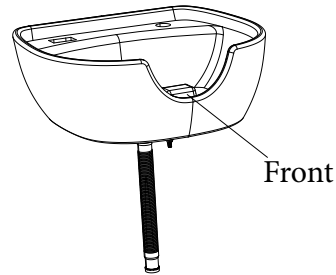

Shampoo chair

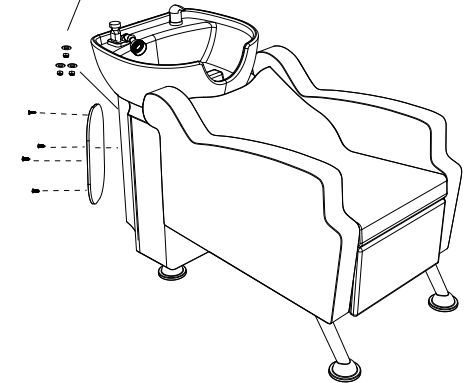
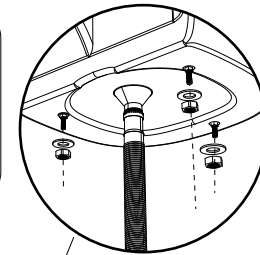
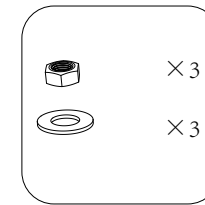
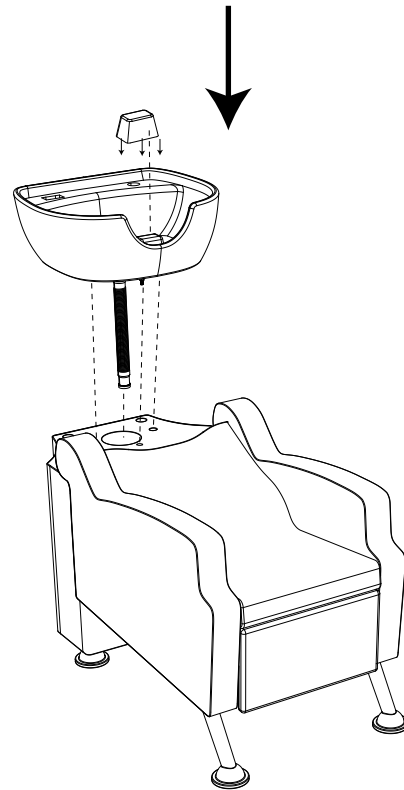
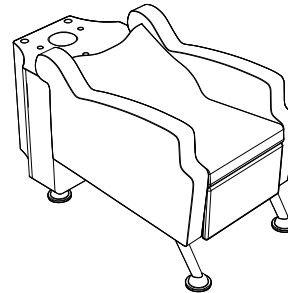

1. To attach the shampoo bowl to the shampoo chair, begin by removing the plumbing access panel located in the back of the shampoo unit and set aside until installation is complete.
2. Next, take the shampoo bowl and ensure that it is facing forward. Remove three nuts and three washers from the bottom as shown in the diagram above. Make sure the bolts at the bottom are aligned with the holes at the top of the shampoo chair.
3. Once the shampoo bowl is aligned and seated at the back of the shampoo chair, attach the shampoo bowl from inside of the shampoo chair using the previously removed nuts. Twist the nuts clockwise to tighten until secure.

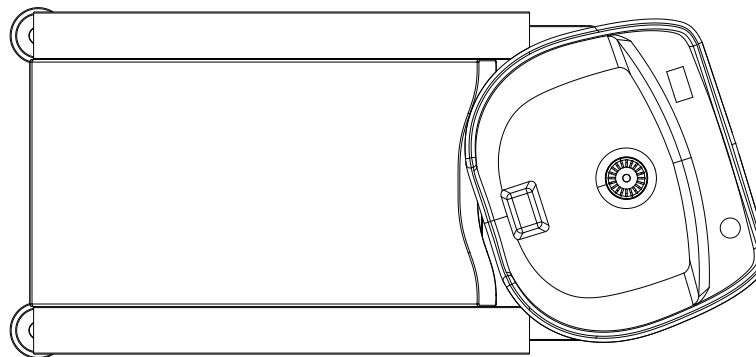
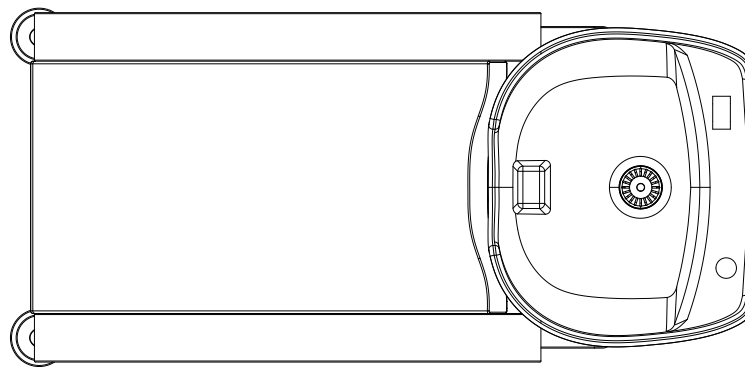
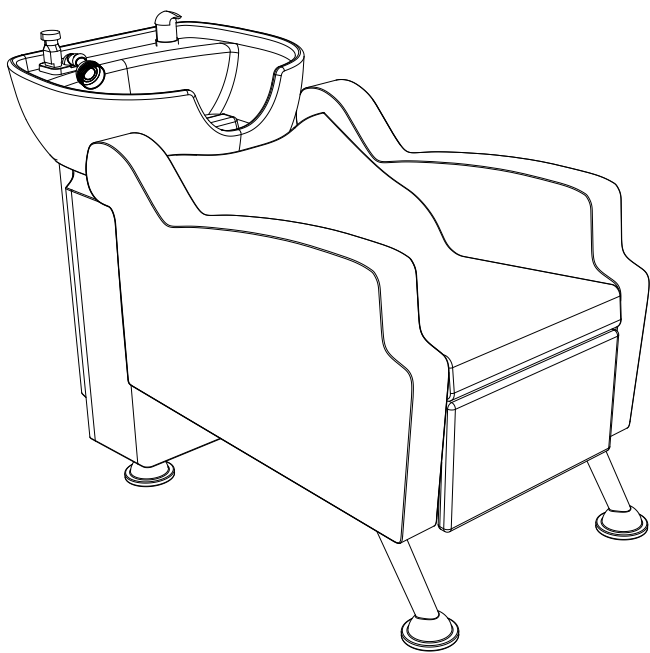

Step 3

Receiver Plate and Shampoo Hose

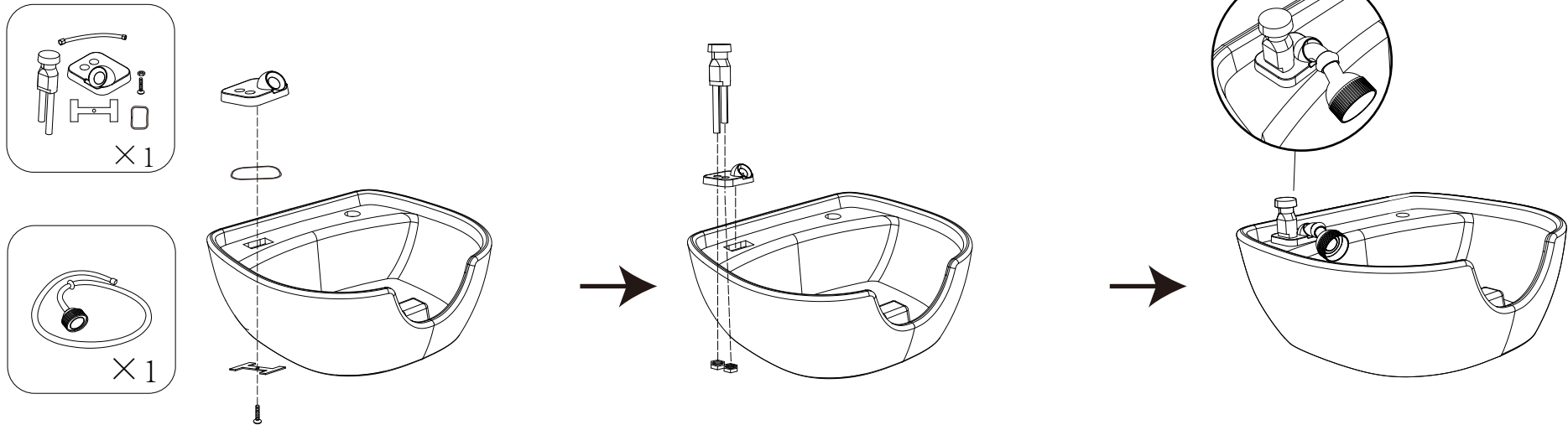

1. Attach the receiver plate to the shampoo bowl using the metal "I" bracket and nut provided.
2. Once the receiver plate is attached, install the shampoo hose and shampoo nozzle that will rest in the receiver plate as shown in the diagram above.
3. Unscrew the 2 metal nuts from the bottom of the vacuum breaker. Once the metal nuts have been removed, place the vacuum breaker in the receiver plate and tighten from underneath. See diagram above.

Step 4

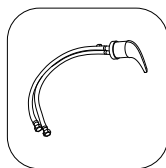

Shampoo Fixture

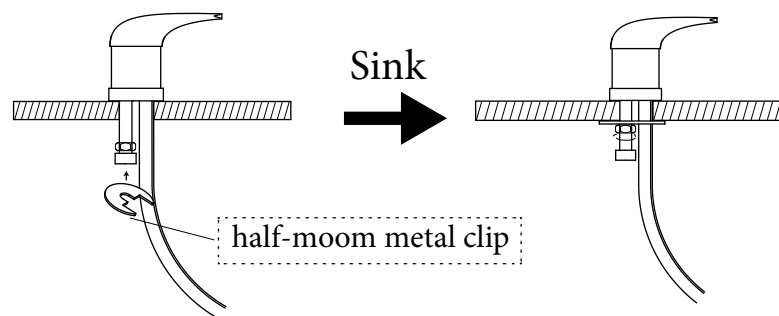
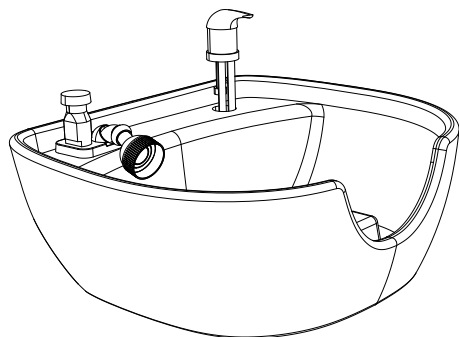

1. Loosen the nut on the bottom of the shampoo fixture to remove the half-moon metal clip.
2. Once the half-moon metal clip has been removed, place the fixture on the shampoo bowl and slide the half-moon metal clip back into place from underneath. Retighten the nut to secure the fixture. See diagram above.

Step 5

Shampoo Hose and Vacuum Breaker Hose

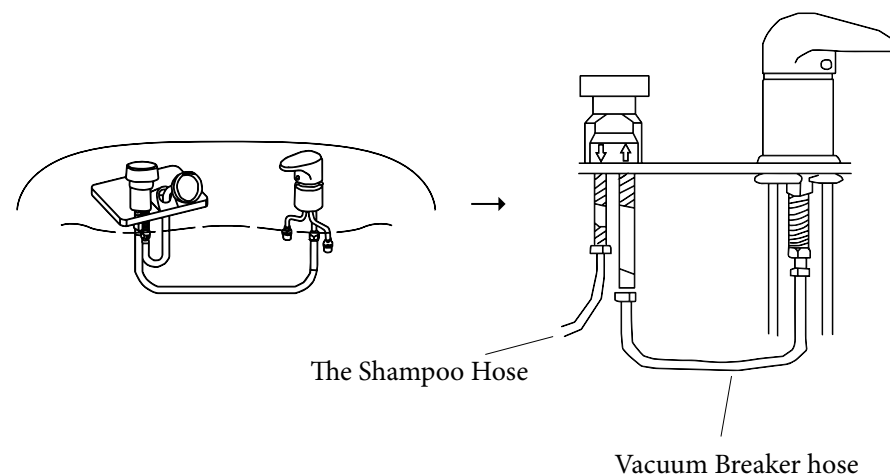

1. Attach the bottom of the shampoo hose to the bottom of the vacuum breaker as shown in the diagram above.
2. Using the vacuum breaker hose, connect the bottom of the vacuum breaker to the bottom of the shampoo fixture as shown in the same image.
3. For proper installation, ensure the shampoo hose is connected to the side of the vacuum breaker marked with a down arrow (↓), and the vacuum breaker hose is connected to the side marked with an up arrow (↑).

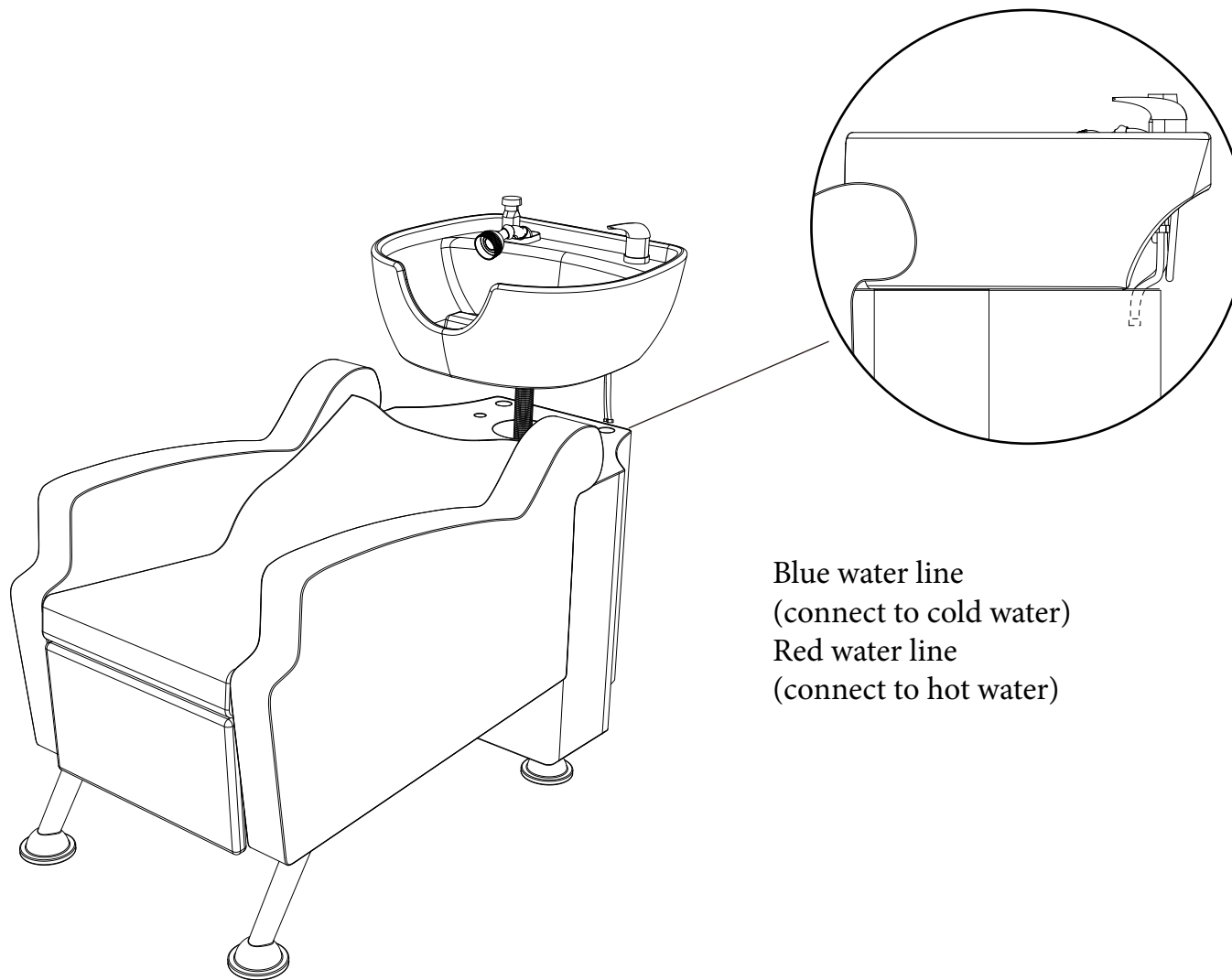

Blue water line
(connect to cold water)
Red water line
(connect to hot water)

Hot and Cold line pass through

Floor plumbing setup:

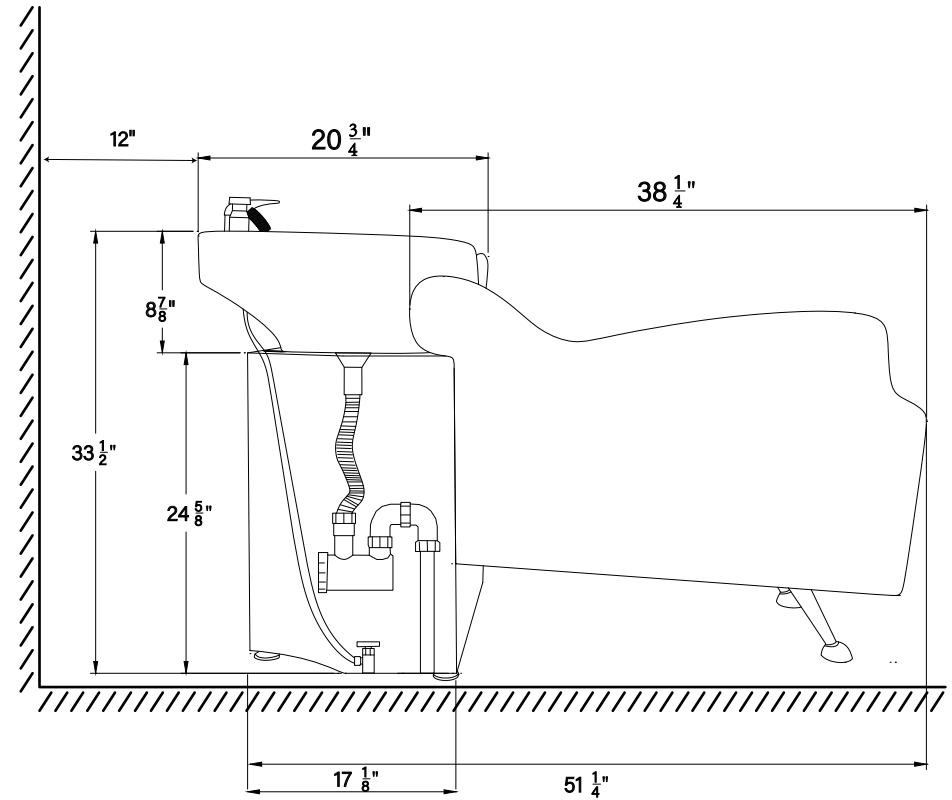
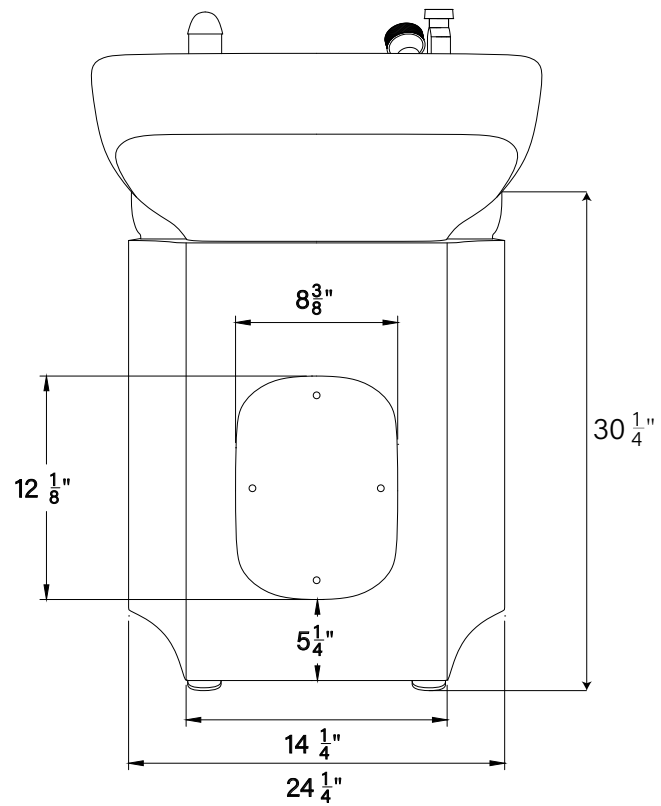

Wall Plumbing setup:

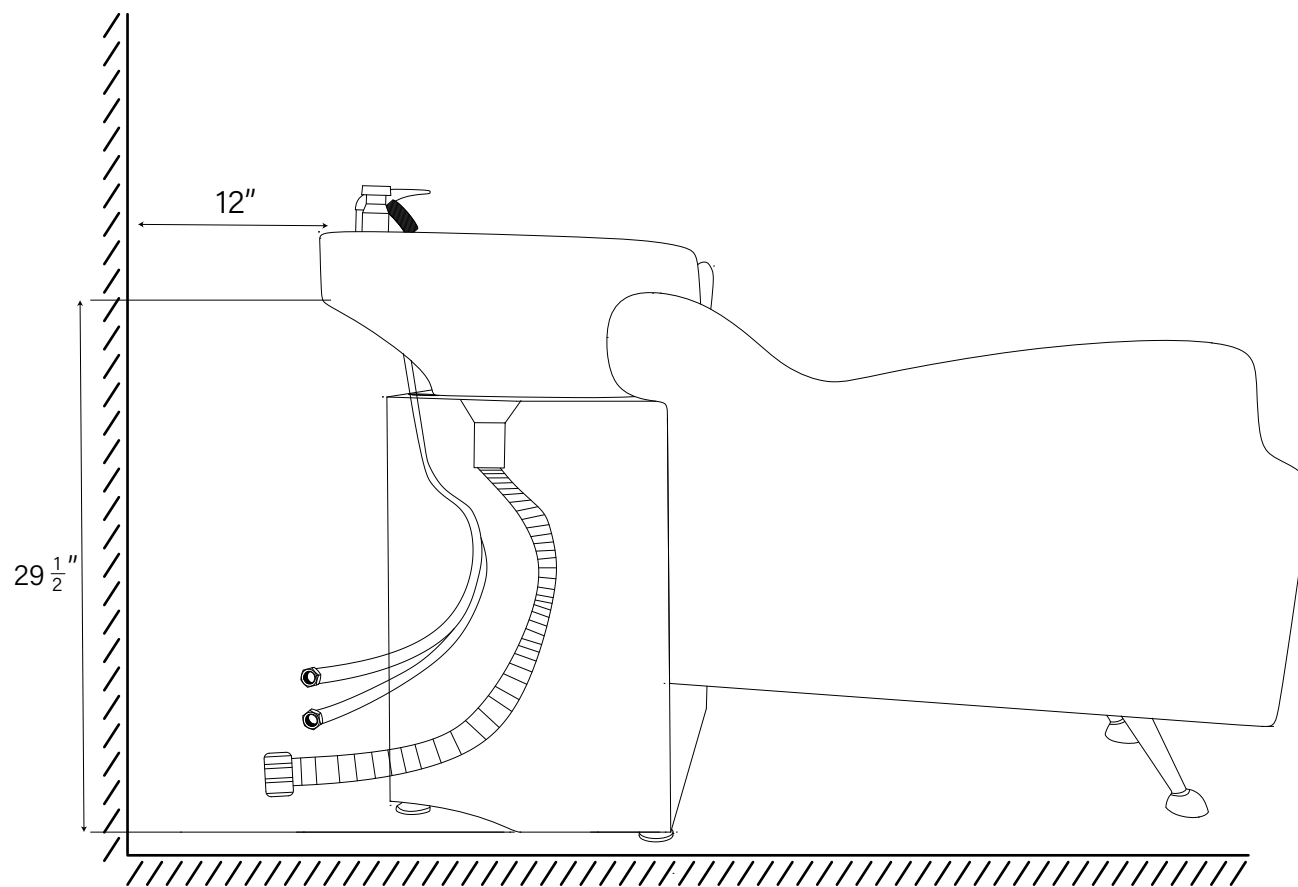

Product care



Brush away excess hair.

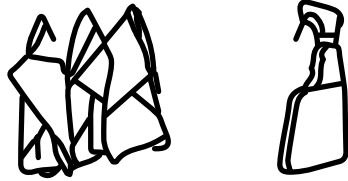

Clean surface with damp cloth or
use simple soap & water solution.



Avoid using corrosive cleaning
agents such as bleaches.

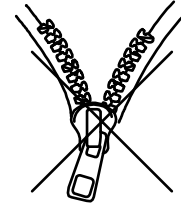

Do not remove upholstery
for cleaning.

Product Information

1. Enjoy your new shampoo chair!
2. For added safety, please be sure to anchor your shampoo unit to the floor with the appropriate hardware for your floor type.
3. Every local jurisdiction will have their own code for how plumbing needs to be installed.
In order to maintain a valid warranty, you must have a license plumber perform the installation.
4. Ensure the drain hose is installed with a downward slope to allow gravity to provide proper drainage.
5. If you have any questions or concerns, please contact our customer experience team at 912-335-4445.