



1-800-477-6655  
buyritebeauty.com

# AVIATOR BARBER CHAIR

YLG-8776

## INSTRUCTION MANUAL



## List of Parts & Tools

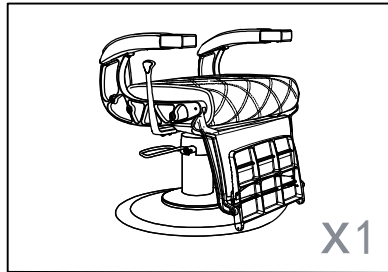

X1

Chair

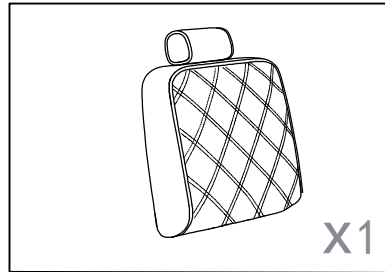

X1

Backrest & Headrest

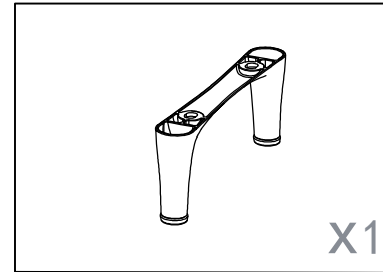

X1

Foot Peg

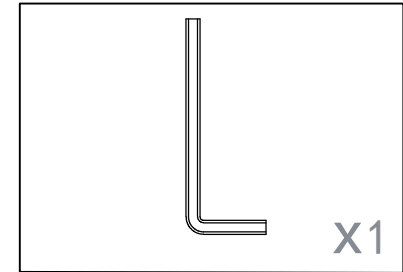

X1

6MM

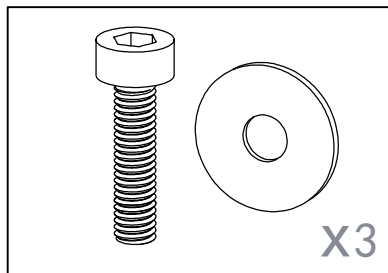

X3

M10 x 35  
Pre-Installed

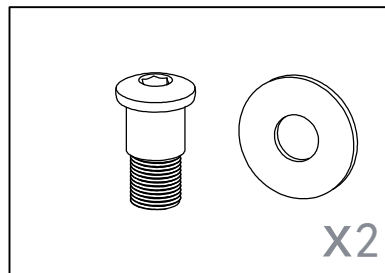

X2

10 x 9 x M8 x 8  
Pre-Installed

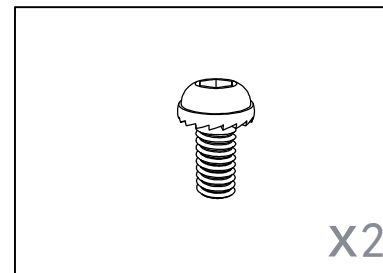

X2

M8 x 16  
Pre-Installed

## Step 1

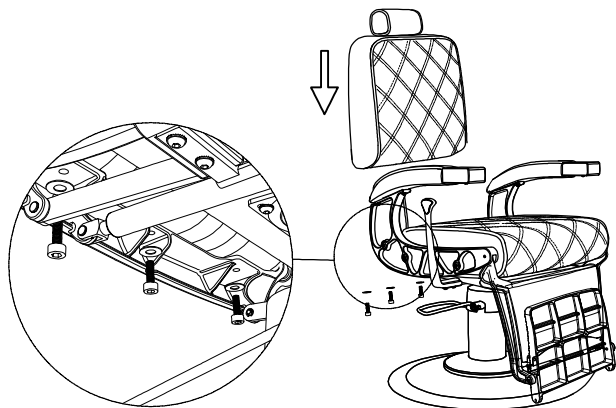
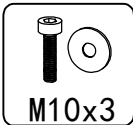

1. Remove the three M10 bolts and washers from the bottom of the backrest and set them aside.
2. Align the backrest so that the mounting holes match the holes on the chair frame.
3. From the underside thread the M10 bolts and washers back into the backrest through the chair frame by hand. Once all 3 bolts are hand-tightened, use a wrench to secure. Alternating to keep even pressure.
4. Apply steady force until they're secure but don't overtighten to avoid stripping the bolts or damaging the frame.

## Step 2

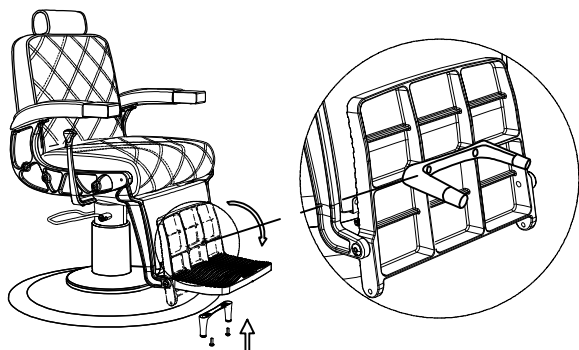
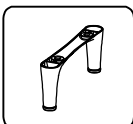
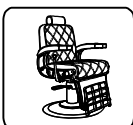

1. Remove the two M8 screws from the underside of the metal footrest and set them aside.
2. Align the holes in the foot peg with the matching holes on the footrest.
3. Reinsert the M8 screws and hand-tighten to hold the foot peg in place.
4. Use the provided wrench to fully tighten the screws. Do not overtighten, as this may damage the threads or mounting surface.

## Step 3

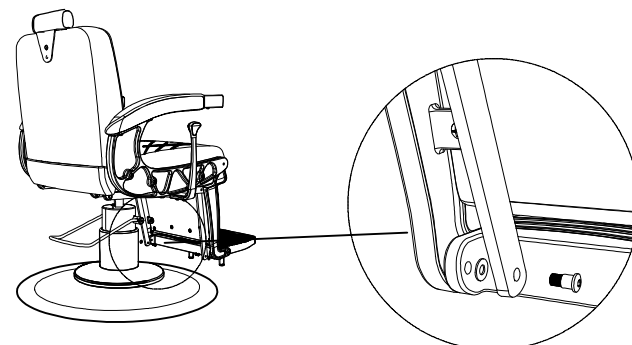

1. Remove the two bolts and washers from the recline bar, slide the recline bars into alignment with the corresponding mounting holes on the metal chair frame.
2. Insert the previously removed bolts and washers through the aligned holes. Use the wrench to tighten the bolts clockwise, ensuring it's fully secured. Avoid overtightening to prevent damage.

## Product care



Brush away excess hair



Clean surface with damp cloth or use simple soap & water solution.

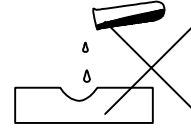

Avoid using corrosive cleaning agents such as bleaches.

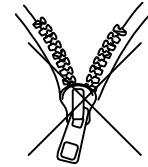

Do not remove upholstery for cleaning

## Product Information

1. Enjoy your new chair!
2. Remember to always keep the hydraulic base in the upright position and never stand solely on the footrest as it will tip.
3. After assembly and before use, we suggest pumping the hydraulic to full height and back down several times to prime the hydraulic fluid. This will keep the pump smooth and responsive.
4. Note that short quick pumping is more effective for adjustments than pressing the lever all the way down each time.
5. If you have any questions or concerns, please contact our customer experience team at 912-335-4445.